

All drawings and related documents are the property of Acton Ostry Architects Inc. and are not to be reproduced in whole or in part without the architect's permission. This drawing shall not be used to calculate area. Do not scale this drawing. All dimensions to be checked on site by the contractor and such dimensions to be their responsibility. All work must comply with the relevant Building Code by Law and related documents. Drawing errors and omissions must be immediately reported to the Architect.

**Issues**  
 08 JUN 2006 VFB Review  
 16 JUN 2006 VFB Review  
 27 JUN 2006 LEED Charette  
 04 JUL 2006 Budget Pricing & Consultants Schematic Design

**revisions**

- Legend**
- 1 concrete retaining wall
  - 2 concrete sidewalk
  - 3 bio-swale
  - 4 2 ply SBR roofing system on steel decking on open web steel trusses
  - 5 green roof system
  - 6 acrylic dome skylight
  - 7 steel and glass canopy with steel column support
  - 8 potential daylighting to be investigated subject to building envelope and performance criteria; potential light diffusing product: Solera translucent insulated glass
  - 9 bench

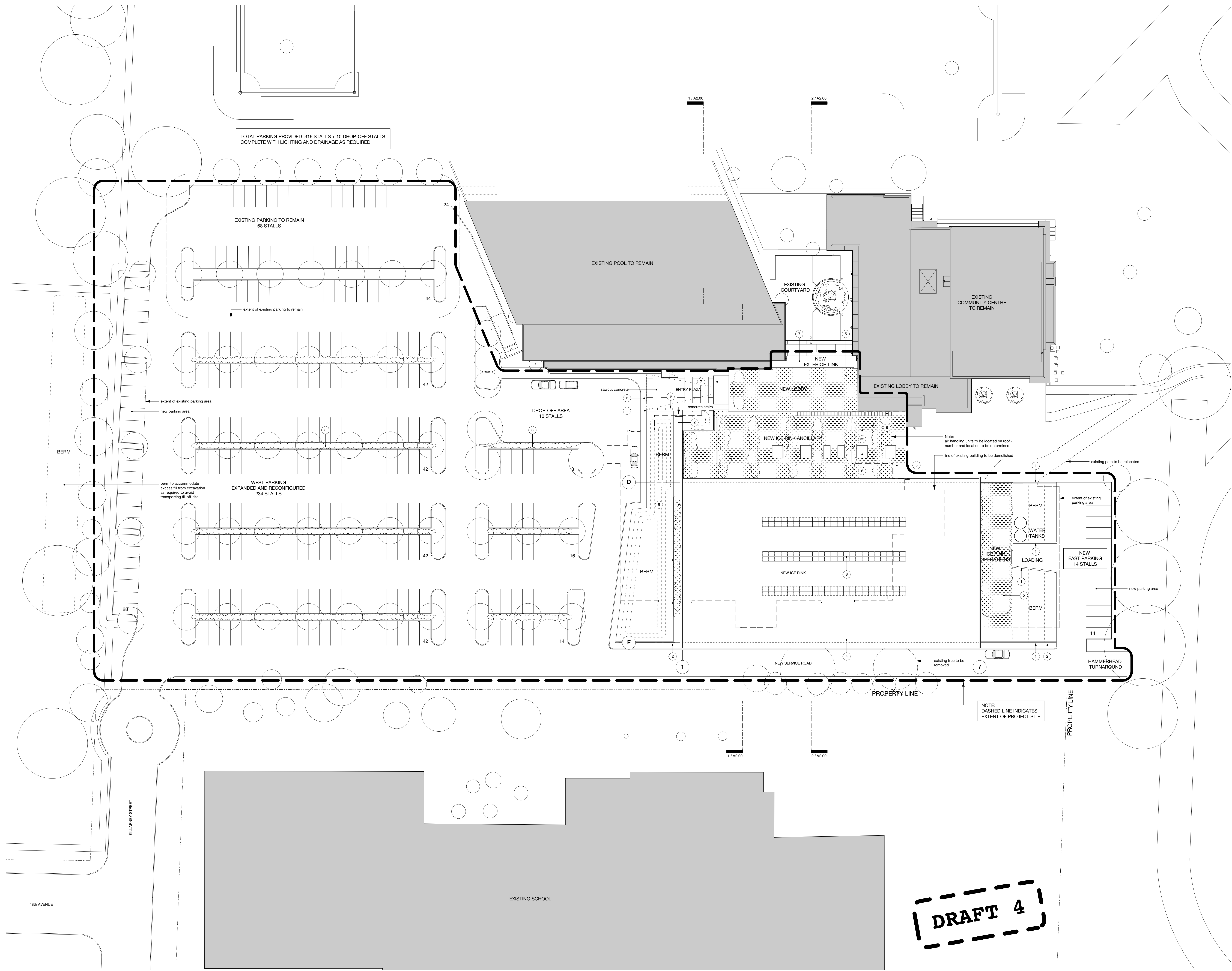

**ACTON OSTRY ARCHITECTS INC.**

1637 W 5 Avenue  
 Vancouver BC  
 Canada V6J 1N5  
 t 604.739.3344  
 f 604.739.3355  
 info@actonostry.ca

**Killarney Ice Rink and Lobby**  
 6260 Killarney Street, Vancouver BC

scale	date
1:300	04 July 2006
project code	status
KIL	DP
drawn	checked
NS	RA

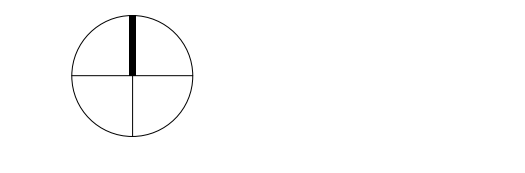

**Site & Roof Plan**

drawing number: **A0.00** revision: #

**DRAFT 4**