

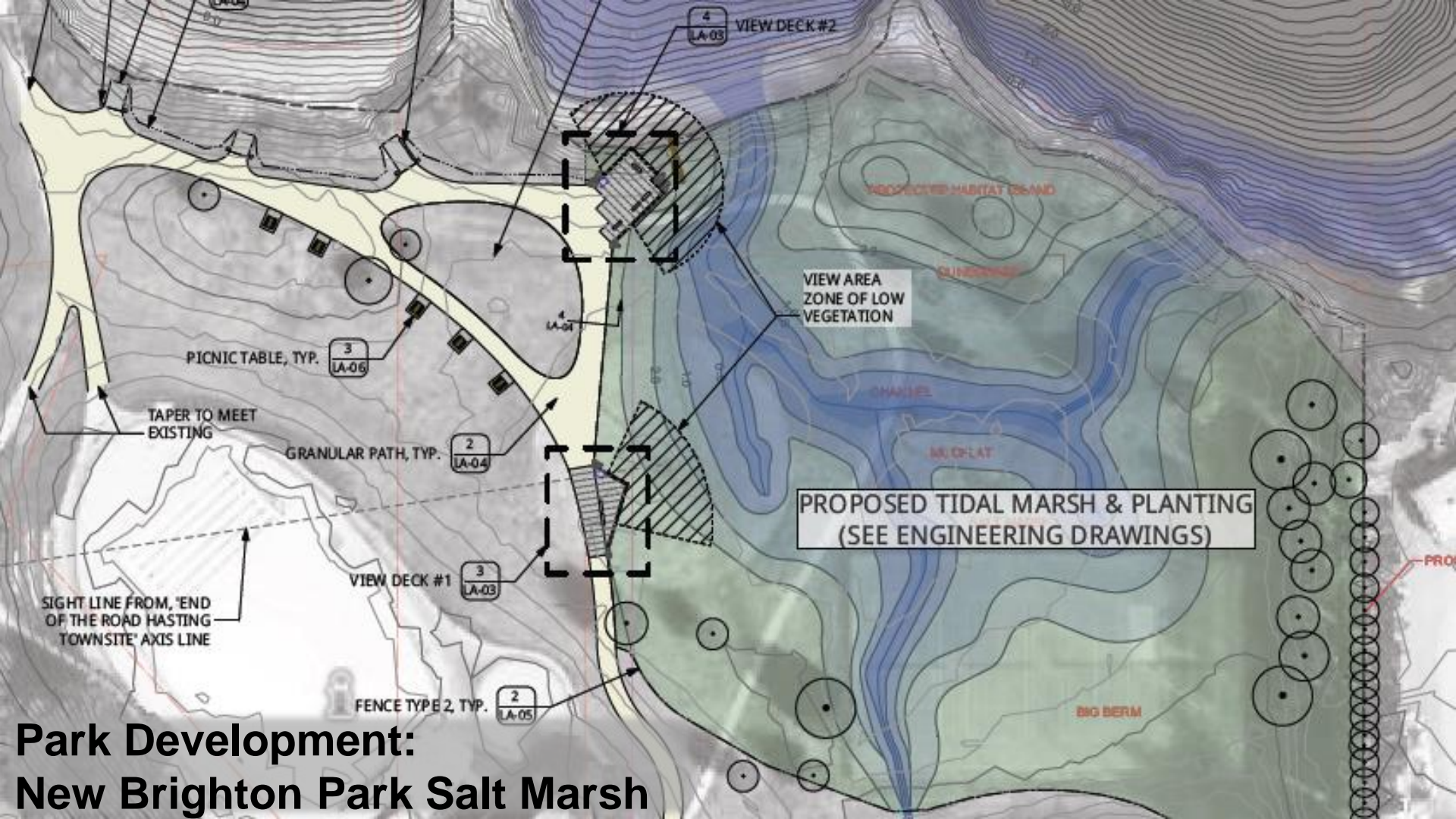

# GENERAL MANAGERS REPORT

Park Board Committee Meeting  
Monday, May 1, 2017





# Park Development: New Brighton Park Salt Marsh





- Return pond to its original condition
- Introduce mechanical system to maintain vitality
- Remove invasive plants
- Koi fish temporarily housed at the Vancouver Aquarium
- Target completion date June 2017

# Park Development: East Fraser Lands Park - Update

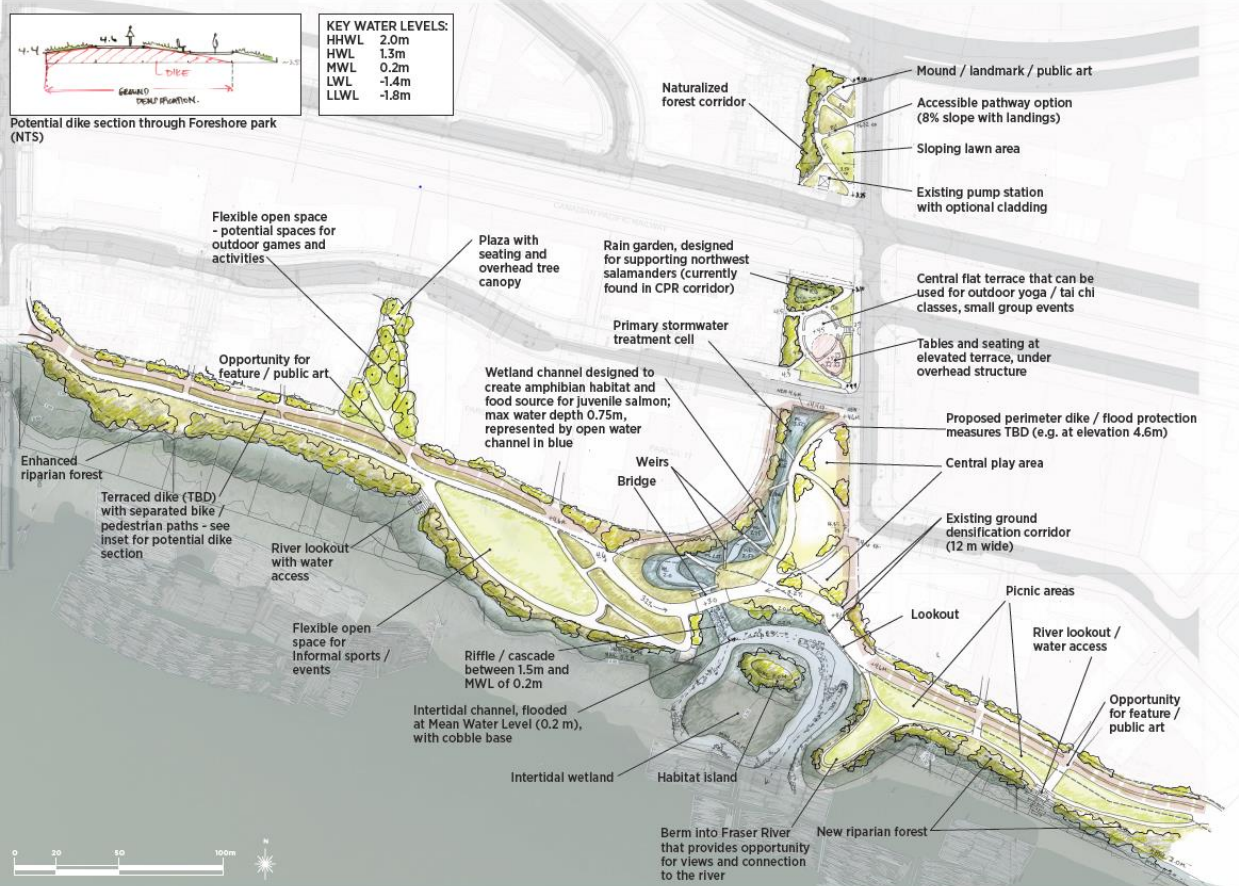

- Up to 12,000 new residents
- Includes 25.2 acres of park land
- 8 acres of park space to be designed and built 2017-2019
- Proposed designs will consider sea-level rise impacts
- Open-house in June



# Park Planning & Research: Non-Motorized Boating Strategy



# Park Development: Ireland Canada Monument



Design Concept A: “Discovering new land”

- Two design concepts provided for public feedback
- Installation proposed for George Wainborn Park

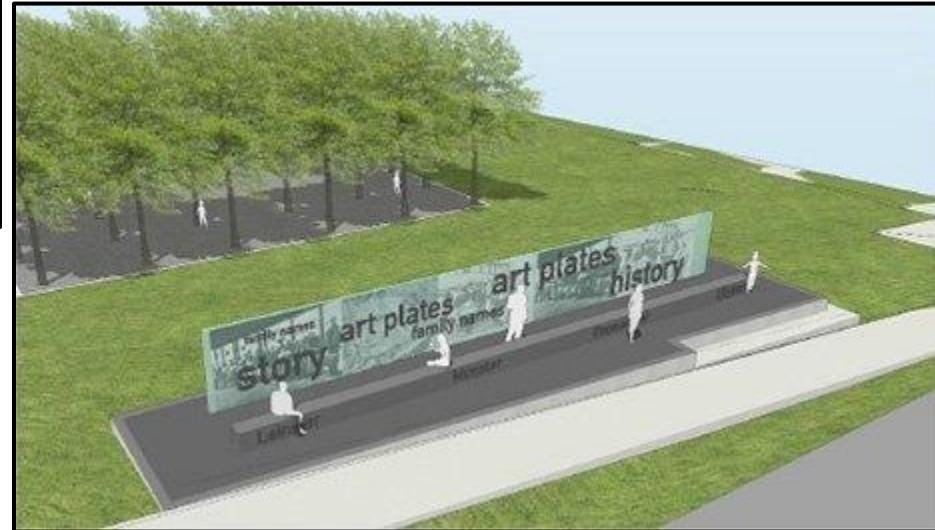

Design Concept B: “Seeing through history”



# Park Development: Urban Forest Strategy & Spring Tree Sale

- Approximately 3,000 trees sold
- 26 varieties such as Venus Dogwood, Full Moon Maple, Chicago Fig, and Cupid Cherry





- Improving, replacing, or closing “once-through” water features to comply with City of Vancouver bylaws
- Improving irrigation practices in parks
- Upgrading large water uses such as Charleson Park waterfall
- Ensuring water conservation goals are incorporated into park development projects
- Improving data collection and analysis around water use





- Park Board approved form of JOA on Apr 10/17
- New JOAs with appendices sent to CCAs on Apr 28/17
- CCAs have 5 months to sign; will take effect Jan 1/18

# Recreation: Marpole-Oakridge Community Centre Renewal

- Park Board leading community engagement process
- Preliminary work ahead of detailed design process
- Focusing on high level service review and site validation





# Recreation: Creekside Community Centre Association

- Developed plan for implementation of a CCA at Creekside
- Establish an advisory committee by Jan 2018
- Determine structure for 2019 budget cycle
- Acceptance of new JOA by existing CCAs essential



# Recreation: Strathcona Sustainable Funding

- Staff working with CCA to develop sustainable funding model for Strathcona Community Centre





# Commercial Operations: False Creek Waterways

- Exploring options to temporarily restricting access to parts of False Creek during the 2017 Dragon Boat Festival
- Working with Transport Canada on both short & long term solutions





- Mar 9/17 - Board approved amending by-laws to restrict import and display of cetaceans in Vancouver parks
- May 15/17 - By-law amendment will be brought forward for enactment by the Board



# Communications: Management of 4/20 Protest Event

- Staff notified neighborhood of impacts via social media, signage, and flyers
- Damage caused to the field at Sunset Beach still being assessed





vancouver  
BIRD WEEK

*Birds at  
the Shore*

*May 6-13, 2017*



Northern Flicker



Varied Thrush



Spotted Towhee



Anna's Hummingbird



# Communications: Stanley Park & Vancouver Park Maps Refresh

## Stanley Park

- Information Booth
- Pay Parking
- First Aid Station (Seasonal)
- "Museum"
- Universal Access Washroom\*
- Gift Shop
- Bookstore
- Concession Stand
- Pkcs Area
- Public Toiletries
- Bus Stop
- Skate Shop (9 AM to 5 PM)
- Big Tree
- Dog Wash Area
- Doggie Society
- Garden
- Viewpoint
- Stanley Park Train
- Basketball
- Golf
- Playground
- Softball
- Swimming
- Tennis
- Water Park

**Attractions**

- Stanley Park Heron-Zimmer Towers
- Brockton Point Interpretive Centre & Gift Shop (Seasonal)
- Mackin-Dow/Thames Under the Stars
- Stanley Park Train
- Prospect Point Lookout & Gift Shop
- Vancouver Aquarium

**Activity Areas**

- Blue Berets (Free Cycle)
- Mountain Bike
- Capriotti Playground
- Tennis Courts
- Lumberman's Arch Picnic Area
- Agnes Agnew Esplanade Field
- Plaza & Trail (Self-Care)
- Prospect Point Picnic Area
- Trolley Square
- Seaside Beach
- Seaside Beach Picnic Area
- Seaside Beach Swimming Pool
- Stanley Park Nature House
- Tennis Courts (Level 1)
- Tennis Courts (English Level)
- Tule Beach
- Seawall Water Park

**Restaurants**

- The Fish House
- Stanley's Bar & Grill
- Prospect Point Restaurant
- The Terrace
- Waterfront Café (Seasonal)

**Points of Interest**

- 67 Fossil Garden of Remembrance (Inset A)
- 68 Kaka Memorial (Inset A)
- Beaver Lake
- Redoubt Strand
- Brockton Point Lookout
- Chief of the Indian Band (Inset B) (Inset B)
- Lark House (Inset B)
- Community Garden
- Express of Japan Signpost
- Gift in a Window Statue
- Henry James Statue
- Horne Colony (Inset A)
- Indian Tree
- Japanese Canadian War Memorial (Inset B)
- Jubilee Fountain (Inset B)
- Lord Charles Stokes (Inset B)
- Lumberman's Arch (Inset B)
- New Old Clock Tower
- Penzance Circle (Inset B)
- Plaque: Johnnie Memorial
- Part of Vancouver Viewpoint
- Portside Pavilion (Inset B)
- Prospect Point Lookout
- Queen Victoria Memorial (Inset B)
- Recreation Oscar Monument
- Robert Burns Statue (Inset B)
- Rock Garden (Inset B)
- Rose and Portland Garden (Inset B)
- Salsbery Demonstration Stream (Inset B)
- Stanley Park Memorial and Garden (Inset A)
- Stanley Park Viewpoint (Inset B)
- Stanley Park Pavilion (Inset B)
- Tennyson, Swan, Frank Williams
- Gardens, Stone to Stone Memorial
- Tule and Mary King (Waterfront)
- Garden (Inset A)

### The Park and Downtown

### A Century-Old Family Favourite

More than 100 years ago, Stanley Park was a family favourite. It has been a place where families have enjoyed the outdoors for over a century. The park's history is rich with stories of families who have spent their summers here. From picnics to playgrounds, Stanley Park has always been a place where families can enjoy the outdoors together.

For more information on the park's history, visit [www.stanleypark.ca](http://www.stanleypark.ca).

### Getting Here

**DRIVING:** From Vancouver, take Georgia Street or South Vancouver, take George Street or South Street and follow the signs. From the North Shore, take Louisa Bridge, Hwy 10 and end of Park Drive, Park Drive to Stanley.

**PARKING:** The parking is divided into several areas. For the visitor parking, Fish House, Terrace, Prospect Point and Brockton Point parking lots are available. For the main parking, see the map.

**TRANSIT:** Public transit services Stanley Park from the city through the Lower Mainland. Several routes serve the perimeter of the park and the ST area near the Brockton Point and Brockton Point area.

**TRAIN BUSES:** Several tour bus companies include Stanley Park in their tours. Contact your tour operator for more information.

**WALKING:** The park is within easy walking distance from downtown, the West End or False Creek. The park is a popular walking route.

### Getting Around

**WALKING:** The park is within easy walking distance from downtown, the West End or False Creek. The park is a popular walking route.

**STANLEY PARK SHUTTLE:** The Stanley Park Shuttle is a free shuttle service that runs from downtown Vancouver to Stanley Park. The shuttle runs from downtown Vancouver to Stanley Park every 15 minutes, from 9:00 AM to 5:00 PM.

