



East Fraser Lands Area 2 Parks – Concept Plan

Park Board Committee Meeting
Monday, November 20, 2017



Purpose of this Presentation

To share information on the public and intergovernmental engagement process and to seek Board approval for the design of the new parks within Area 2 of the East Fraser Lands development.

Guidelines and Strategies

- EFL Design Guidelines - 2008
- Park Board Strategic Framework
- Biodiversity Strategy
- Climate Change Adaptation Strategy
- Bird Strategy
- Greenest City Action Plan
- Urban Forest Strategy
- Healthy City Strategy
- Transportation 2040



Vancouver
Bird Strategy

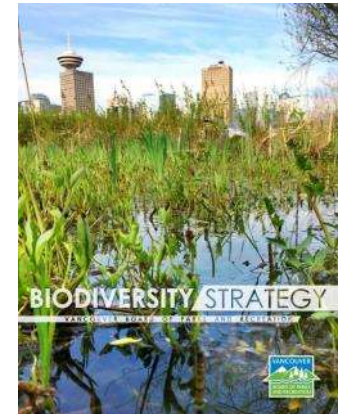

- Phase 1. Background Studies and Context Analysis
- Phase 2. Flood Protection Study
- Phase 3. Public Engagement and Conceptual Design
- Phase 4. Board Approval
- Phase 5. Detailed and Technical Design
- Phase 6. Tendering and Contract Award
- Phase 7. Construction



Context



Context



View northwest toward Kinross & Foreshore



View south toward Kinross South & Foreshore



View east along Foreshore from Kerr



View west along Foreshore



View east along Foreshore



View west from Foreshore to Kerr

- 128 acre site formerly occupied by Whitepine Sawmill
- Now being developed by Wesgroup based on 2004 Policy Statement and 2006 ODP
- 15,000 new residents when complete
- 25 acres of parks to be built to serve community
- First park completed in 2012 (Neighbourhood Park North)
- Space-2-Place (consultant) leading park design process
- 7.78 acres of parks will be developed through this initiative

FRASER RIVER CONDITION

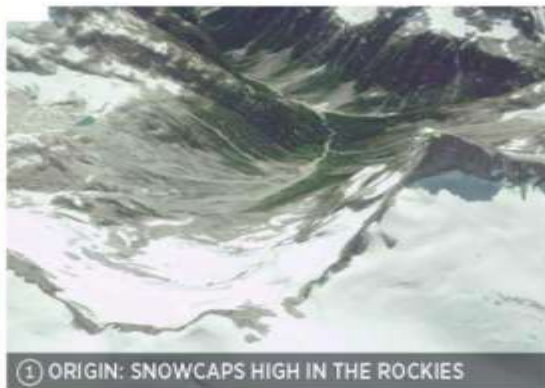

FRASER RIVER CULTURAL HISTORY

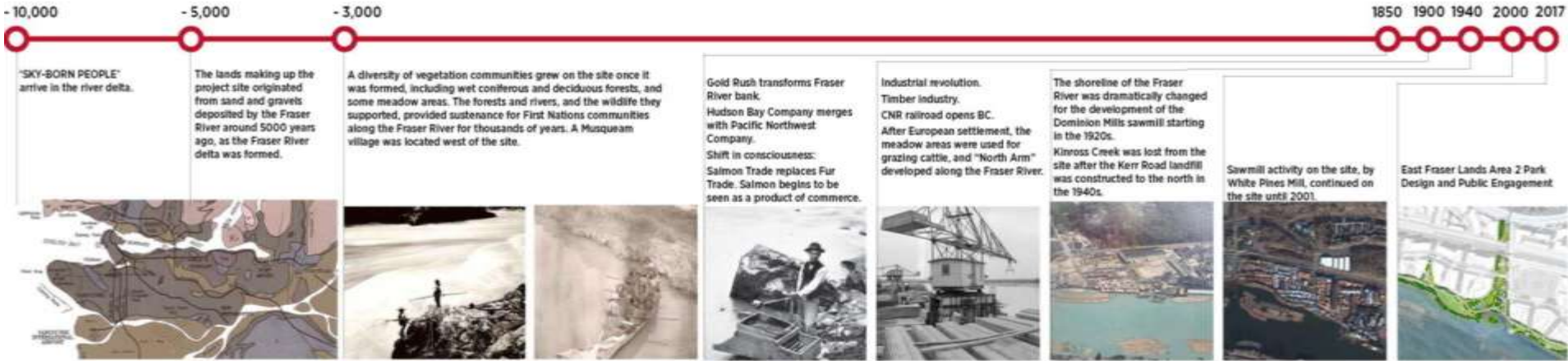

Area 2 Parks



LEGEND

Parks

-  ① Neighbourhood Park North
- ② Neighbourhood Park South
- ③ Kinross Park North
- ④ Kinross Park South
- ⑤ Playfield Park
- ⑥ Foreshore Park

Parks Conceptual Diagram
1:3000





Design Guidelines

- Create Resilient Natural Systems
- Foster a Unique Identity That Celebrates The Site's Past, Present & Future
- Cultivate Community Interactions & Recreation Opportunities
- Establish Connections to Adjacent Neighbourhoods & Parks

- First Nations Engagement:
- Project referral sheet submitted to the Musqueam, Squamish, and Tsleil-Waututh First Nations
- Park Board will be working with the Musqueam, Squamish, and Tsleil-Waututh First Nations throughout the course of the project to better understand their needs and aspirations.
- Opportunities for interpretation of cultural resources and public art (i.e. New Brighton Park)

- Open House #1 (October 15, 2016)
 - 2-concepts presented based on design guidelines and principles
 - 10am - 1pm at River District Farmer's Market
 - 50 attendees
 - 91 respondents to survey (online for 3-weeks)
 - Feedback was positive and community was supportive of the parks being constructed soon
 - Most residents were from West and East Fraser Lands

CONCEPT 1

This concept has an emphasis on large, flexible park areas that could be used for informal sports, community events, or cultural celebrations. Two smaller play areas (Middle Kinross Park, Neighbourhood Park South) provide space for children and families in the area. Park elements and public art focus on the site's rich cultural stories, including the history of the saw mill and the relationship of First Nations with the land and river.



-  Flexible cultural gathering area
-  Landmark / feature public art



CONCEPT 2

This concept features a network of smaller nodes of activity where people can connect with and learn about nature and the river. There are also larger flexible spaces for group gatherings and community events, and a big play area in Foreshore Park West, with a focus on natural play elements. This concept emphasizes establishing generous ecological corridors through the site, including a north-south connection to the natural area to the north, and an east-west connection to the Fraser River foreshore.

SITE ORGANIZATION DIAGRAM

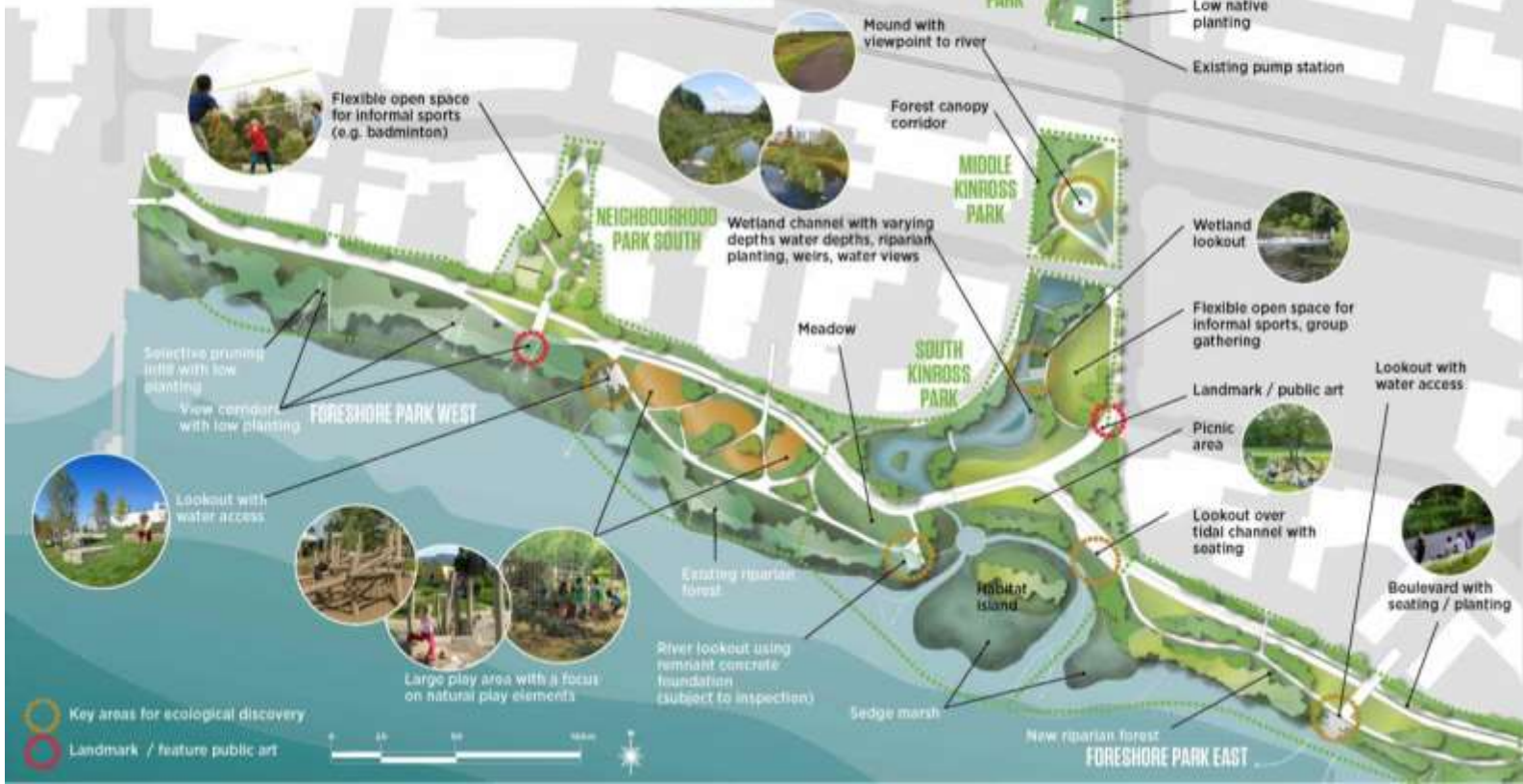

Flood Protection Study

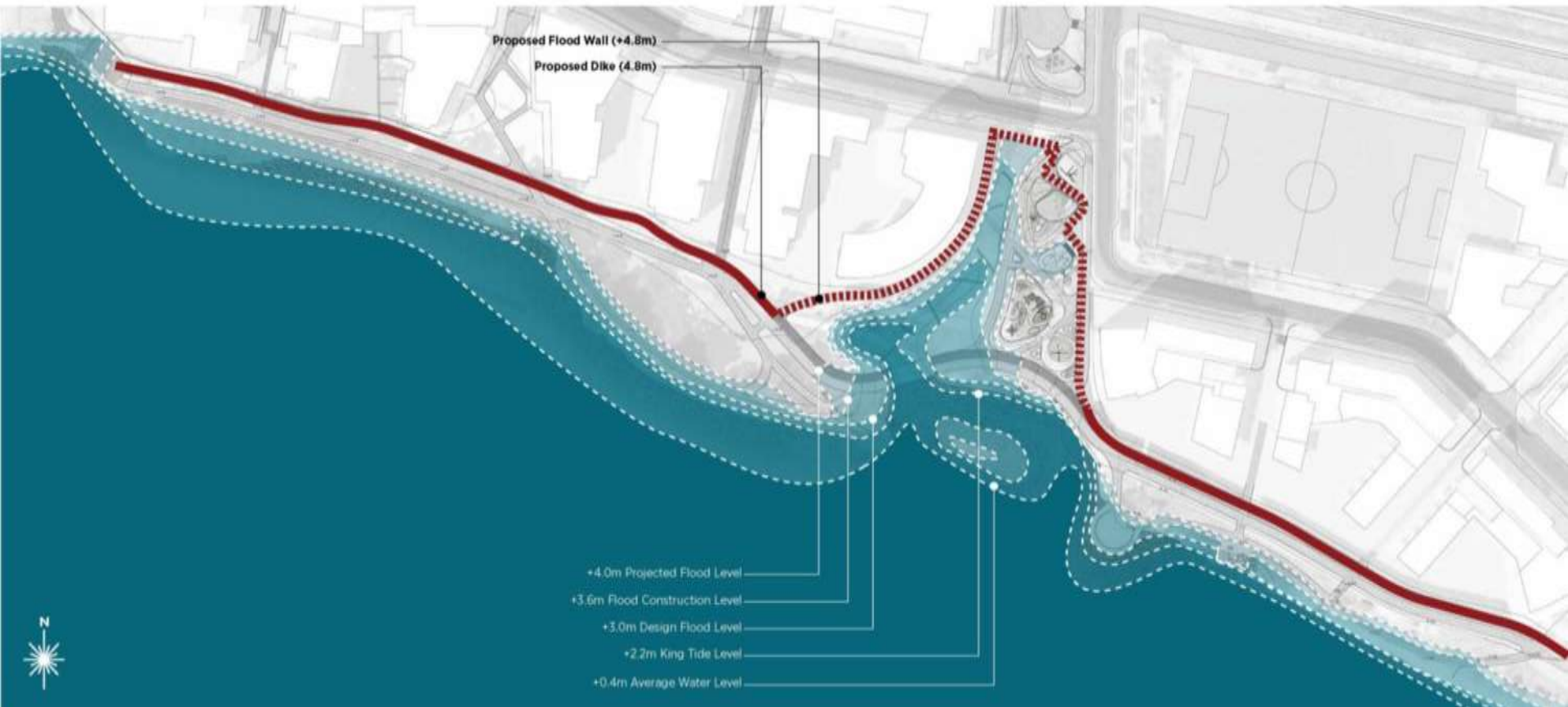

Flood Protection Study

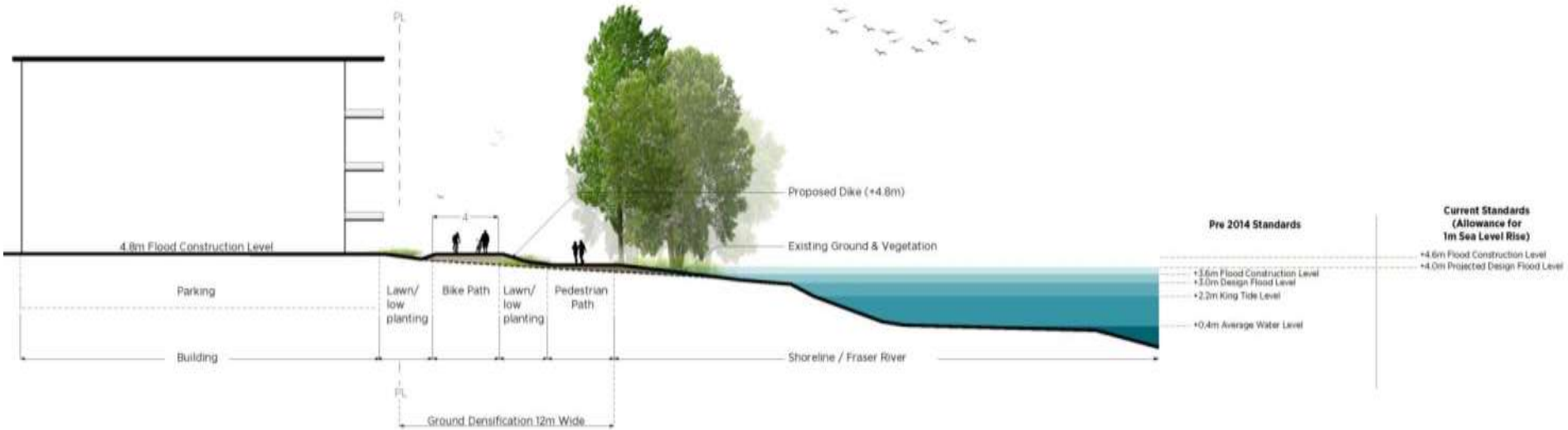

- Open House #2 (September 9, 2017)
 - Preferred concept based on design guidelines, design principles, open house #1 and Flood Protection Study
 - 10am - 2pm at River District Farmer's Market
 - 50 attendees
 - 109 respondents to survey (open online for 3-weeks)
 - 79% of respondents supported design, 14% were neutral, and 7% did not support the design
 - Key needs identified are a washroom and enhancing the lushness of vegetation along the Kinross Corridor

OVERALL CONCEPT PLAN





FORESHORE PARK

NEIGHBOURHOOD PARK SOUTH

SOUTH KINROSS PARK

MIDDLE KINROSS PARK

NORTH KINROSS PARK



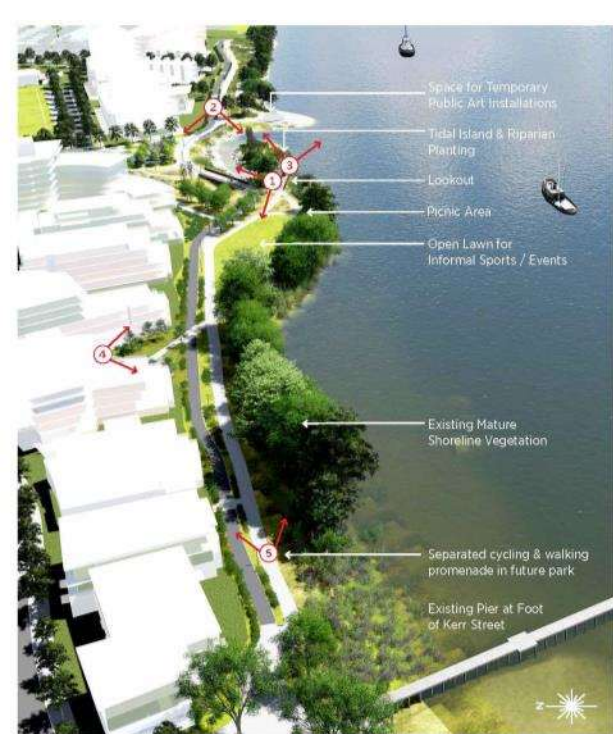



1 View from Riverwalk Avenue into South Kinross Park and Terraced Wetland Habitat



2 Tidal Island adds Habitat Diversity Throughout Site



3 Central Playscape Encourages Outdoor Exploration & Discovery



4 Playscape Provides Focal Point & Welcomes the Community into the Site



SOUTH KINROSS PLAYSPACE



1 View of Washroom within South Kinross Playspace



2 View of Washroom from Foreshore Park Promenade / Stepping off the Bridge



3 View of Washroom looking West within South Kinross Playspace



4 View of Washroom from Kinross Street

PLANTING TYPOLOGIES WITHIN EAST FRASER LANDS



Low Maintenance Native Planting Along Promenade



Shaded Woodland



Woodland Understory



Wetland & Rain Garden



Existing Mature Vegetation along Shoreline Infilled with Additional Riparian Planting



Riparian Planting Along Shoreline & Tidal Island



Playscape



- Detailed design and cost analysis (Preliminary budget \$12M)
- Spring 2018 - Tender Neighbourhood Park South, Middle-Kinross and North-Kinross Park for construction (completion mid-2019)
- Summer 2018 – Seismic Enhancement to Foreshore
- Winter 2019 – Tender foreshore dyke and Foreshore Park construction
- Summer 2019 - Construction of foreshore dyke and Foreshore Park
- 2020 – Complete Construction of Foreshore Park
- 2021 - Park Opening Celebration



THAT the Vancouver Park Board approve the final design plan for the new parks within Area 2 of the East Fraser Lands as illustrated and described in this report.



OVERALL CONCEPT PLAN



