



WEST END WATERFRONT MASTER PLAN Update

Regular Board Meeting
Monday, October 30, 2023



To provide an update on the draft final concept plan for the Imagine West End Waterfront project ahead of the final round of engagement.



RECONCILIATION MISSION, VISION & VALUES

MISSION

Decolonize the Vancouver Park Board

The Park Board recognizes the institution's colonial history and upholds the Board's commitment to the 11 Reconciliation Strategies.

VISION

An evolvable organization in which every employee and Commissioner recognizes the humanity in themselves by recognizing and respecting the humanity of First Peoples; and an organization that sets a worldwide example in treating Reconciliation as a decolonization process.

VALUES

These values are your compass to help guide the way you work, interact with colleagues, external partners and the public.



PATIENCE

Colonialism didn't happen overnight. Untangling it takes time. We will pace ourselves for the marathon, not the sprint. We will adjust deadlines to ensure things are done well and respectfully.



CLARITY

We will focus on how colonialism functions to exclude, not on how to include.



PRAGMATISM

All staff are inheriting a system not of our making. The Park Board Reconciliation Team (PBRT) is here to assist colleagues with examining the ways colonialism continues to damage others. Blame is unproductive.



LEADERSHIP

We will nurture and sustain each other, demonstrating Indigenous principles in the way we function as a team.



LEARNING

We consent to learn in public. We will make mistakes. We will sit with those mistakes, be transparent about them, and use them both to learn and to teach. Our mistakes will be diagnostic tools.



- Introduction
- Round 2 Engagement Summary
- Draft Concept Plan
- Implementation Framework
- Next Steps
- Q&A



Project Timeline



Project Study Area

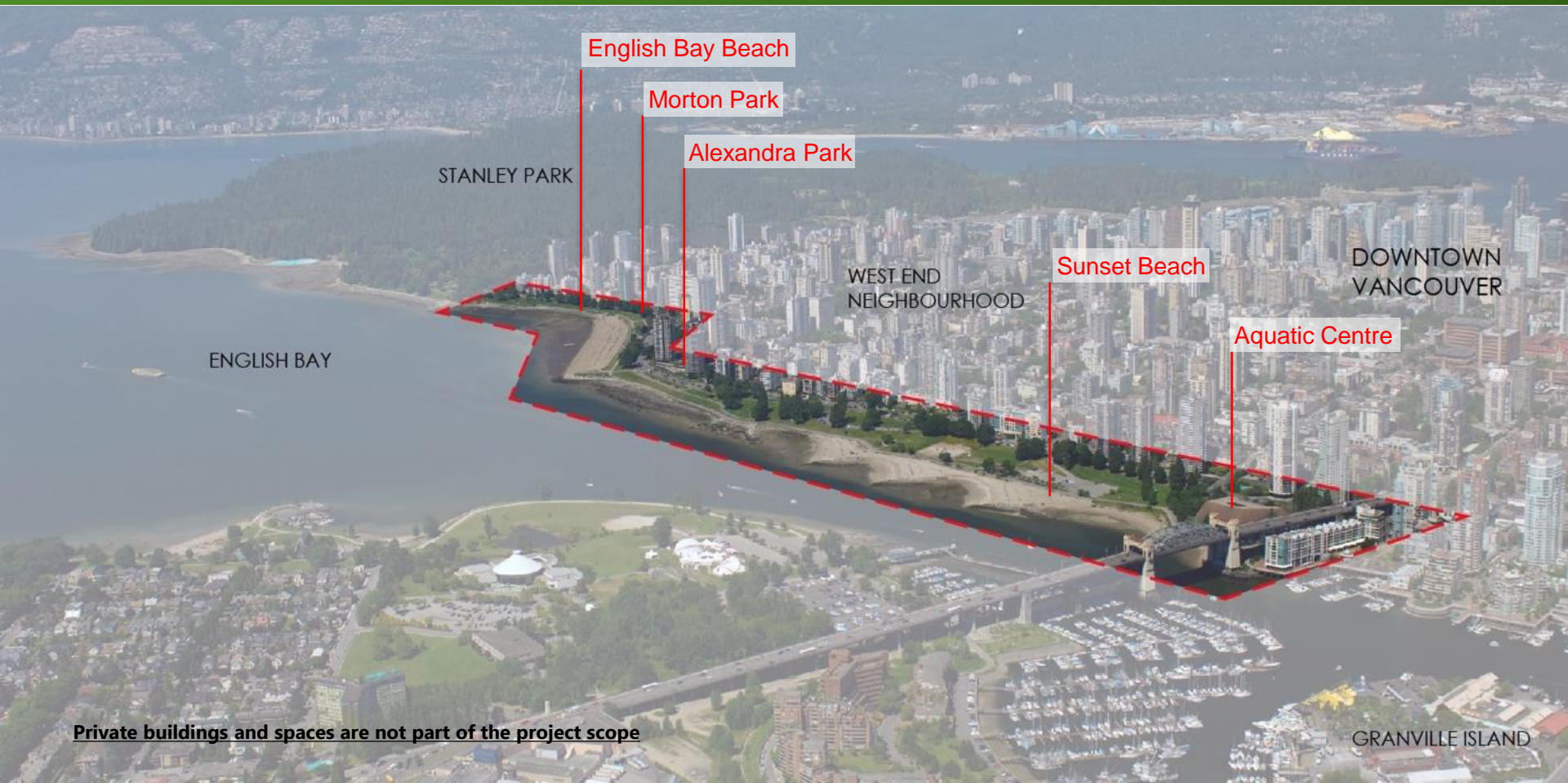

Private buildings and spaces are not part of the project scope

Why are Waterfront Parks Important to Vancouver

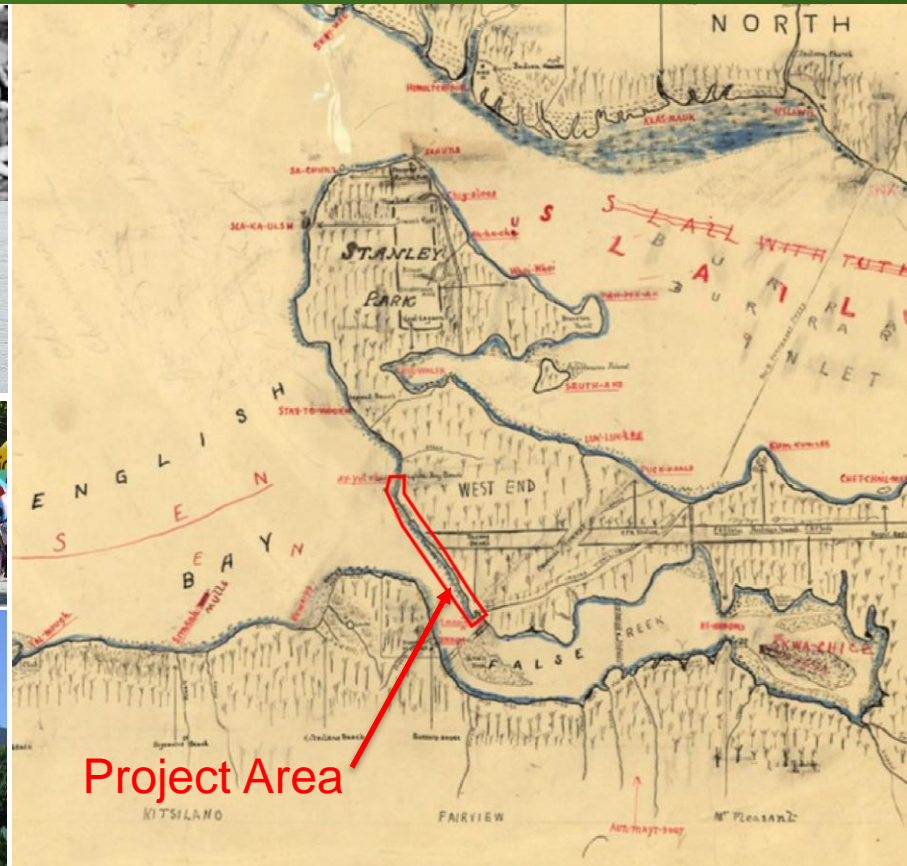

Major Matthews, City Archivist 1933-1970, conversations with Squamish Chief August Jack Khatsahlano

- **Building trust and relationships** with Host Nations through meaningful process.
- **Providing space and flexibility** in the draft conceptual design for M,S,T-led projects and cultural practice areas
- **Setting the framework for design development** that integrates Indigenous ecological expertise, restores Indigenous place names and language use, and includes Coast Salish design and art.

- Through our intern-governmental relationship with the Host Nations, welcoming opportunities for cultural recognition and visual representation in parks, including Indigenous artwork;
- Take a cautious approach when dealing with impacts to Indigenous cultural heritage;
- Achieve a ‘net environmental gain’;
- Use native plant species consistent with local ecology, and provide material from any removed trees for cultural use;
- Flood protection against sea level rise, improved foreshore habitat, reduce pollution and light pollution.

Round 2 Engagement Summary



Round 2 of Engagement: Three Design Strategies

Weave



Carve



Seed



Round 2 Engagement: 2000+ Responses



In-person stakeholder workshops (32 participants)



Community Advisory Group (15 volunteer members of the public)



Online Survey (1,477 respondents)



Shape Your City – love letters to the West End Waterfront (49 letters)



Virtual workshops (30 participants)



Pop-ups at English Bay and the Gathering Place CC (approximately 320 interactions)



Children & Youth Planning/Design Program (3 schools, 85 students)



Ongoing conversations with impacted groups and equity-deserving communities

Round 2 Engagement: Key Themes and Takeaways

- Overall agreement with the Vision, Principles, and Goals:
 - the commitment to an environmentally resilient place
 - a joyful place where people of all ages can gather
 - a connected place that acknowledges the unique characteristics of the West End neighbourhood.

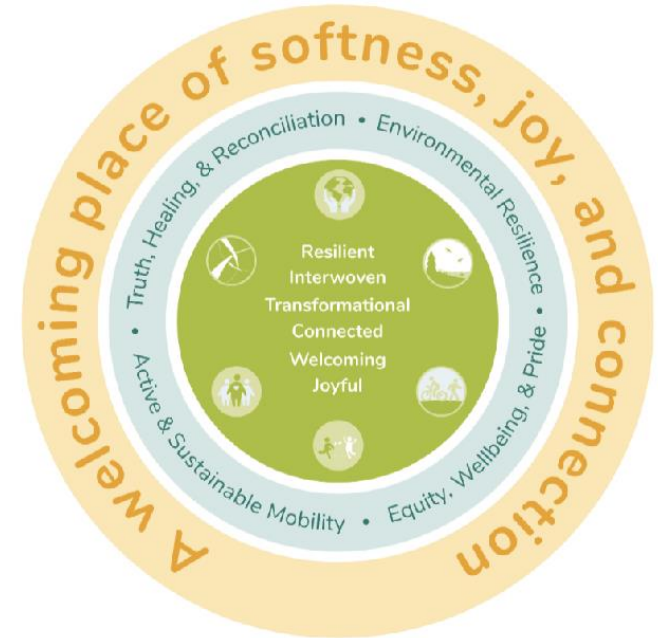

Round 2 Engagement: Key Themes and Takeaways

- Most would like to see:
 - **a mix of active and passive uses** throughout the site, including existing events.
 - **improved facilities** like washrooms, changing areas, and water stations. Some would like better access to the water.
 - **active and sustainable transportation** prioritized, while ensuring that residents and visitors who drive continue to be able to access the area and park near their destinations.
 - Deep appreciation for the **quiet, peaceful and green qualities** of the area today.

Draft Concept Plan



Draft Concept Plan – A Flexible 30 Year Vision



Conceptual plan only; subject to future funding and detailed planning/design

Draft Concept Plan – Sea Level Rise



Draft Concept Plan – Sea Level Rise Strategies

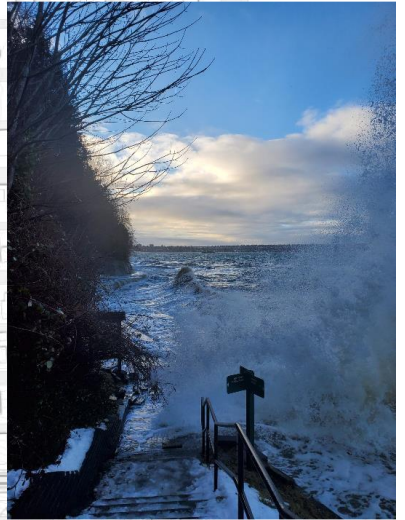
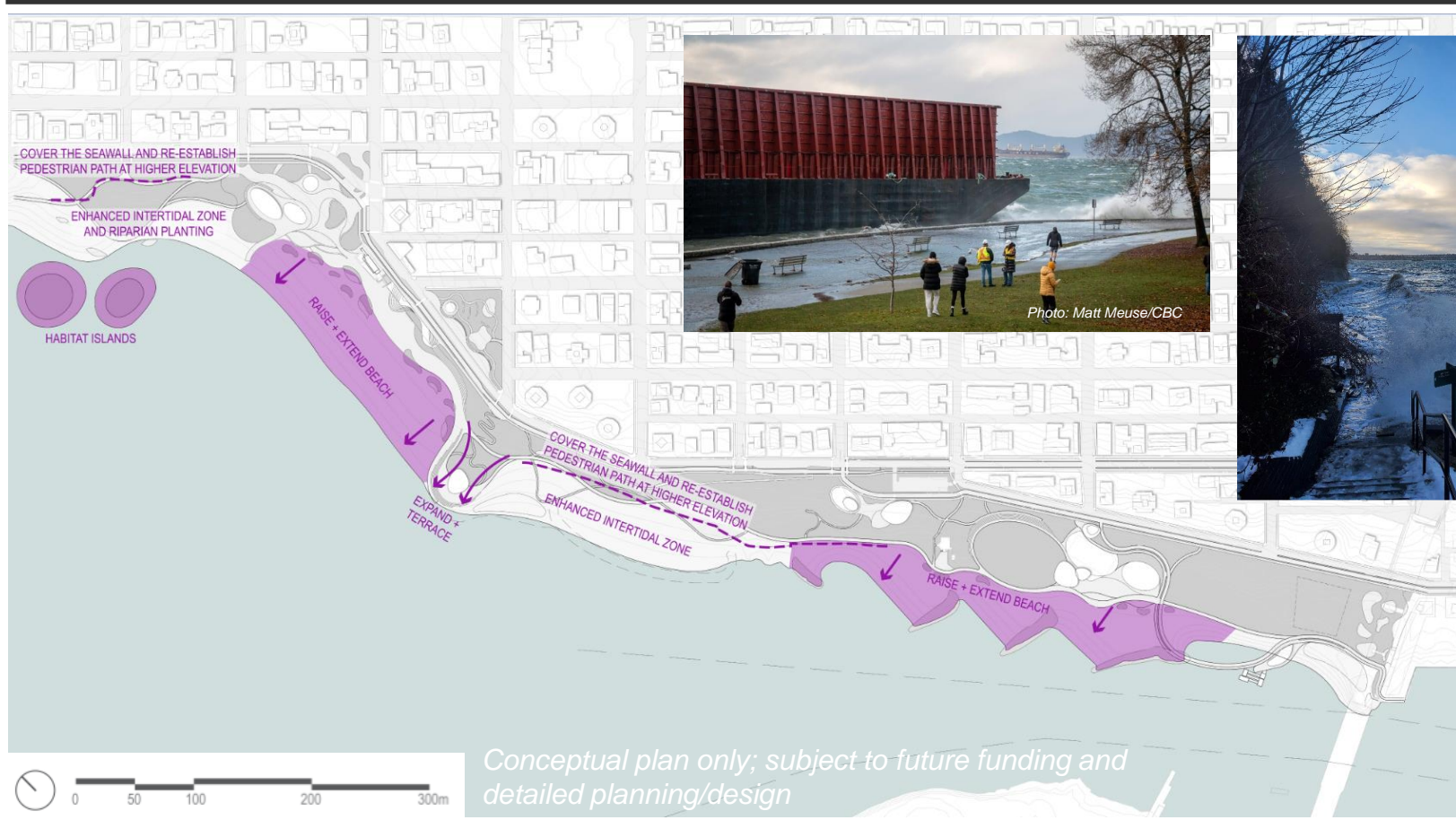

Conceptual plan only; subject to future funding and detailed planning/design

Draft Concept Plan – Facilities, Amenities and Destinations

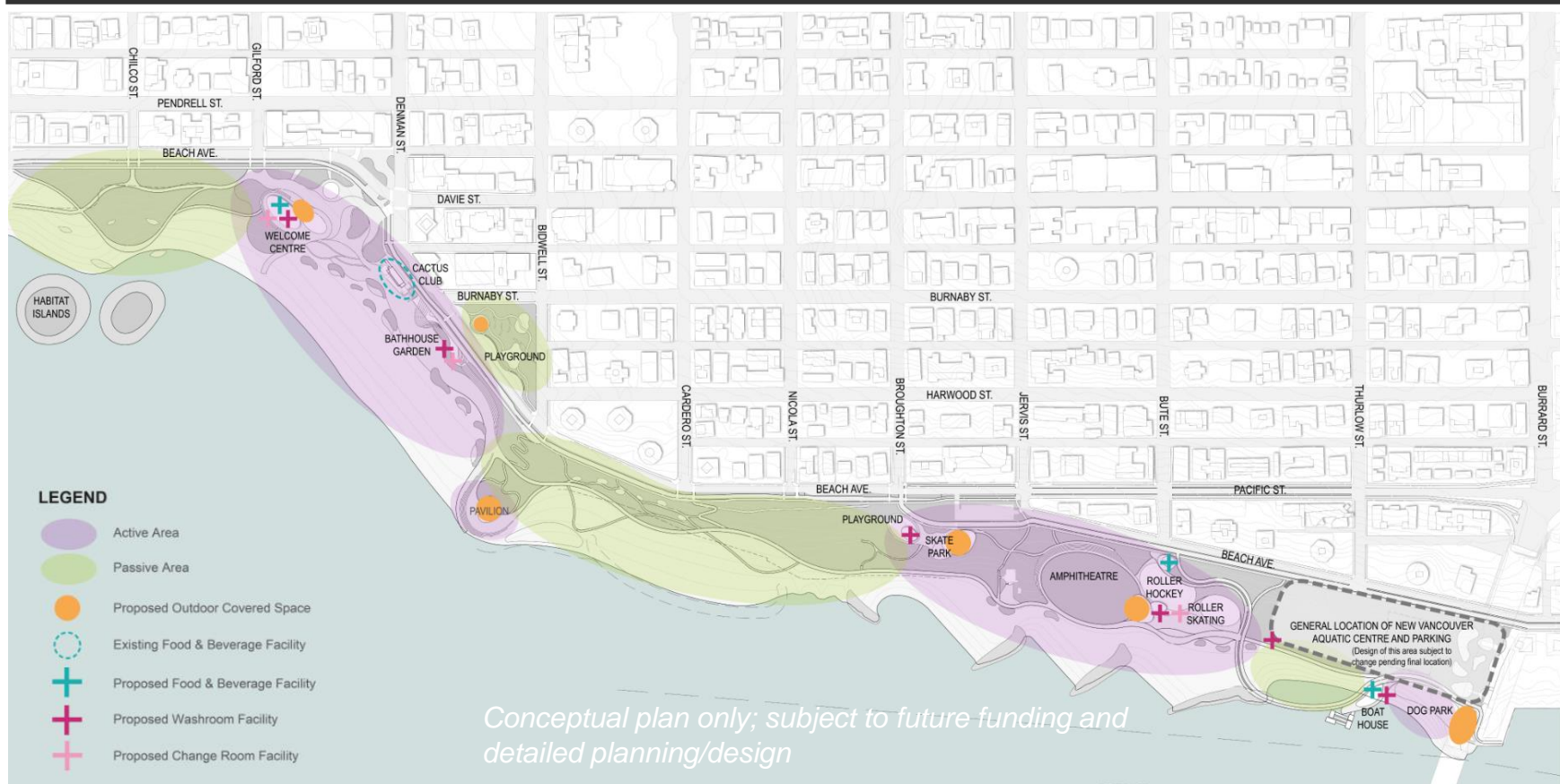

Draft Concept Plan – Walking and Cycling



Draft Concept Plan – Transit and Motor Vehicle



Draft Concept Plan – West: Habitat Island and Welcome Centre

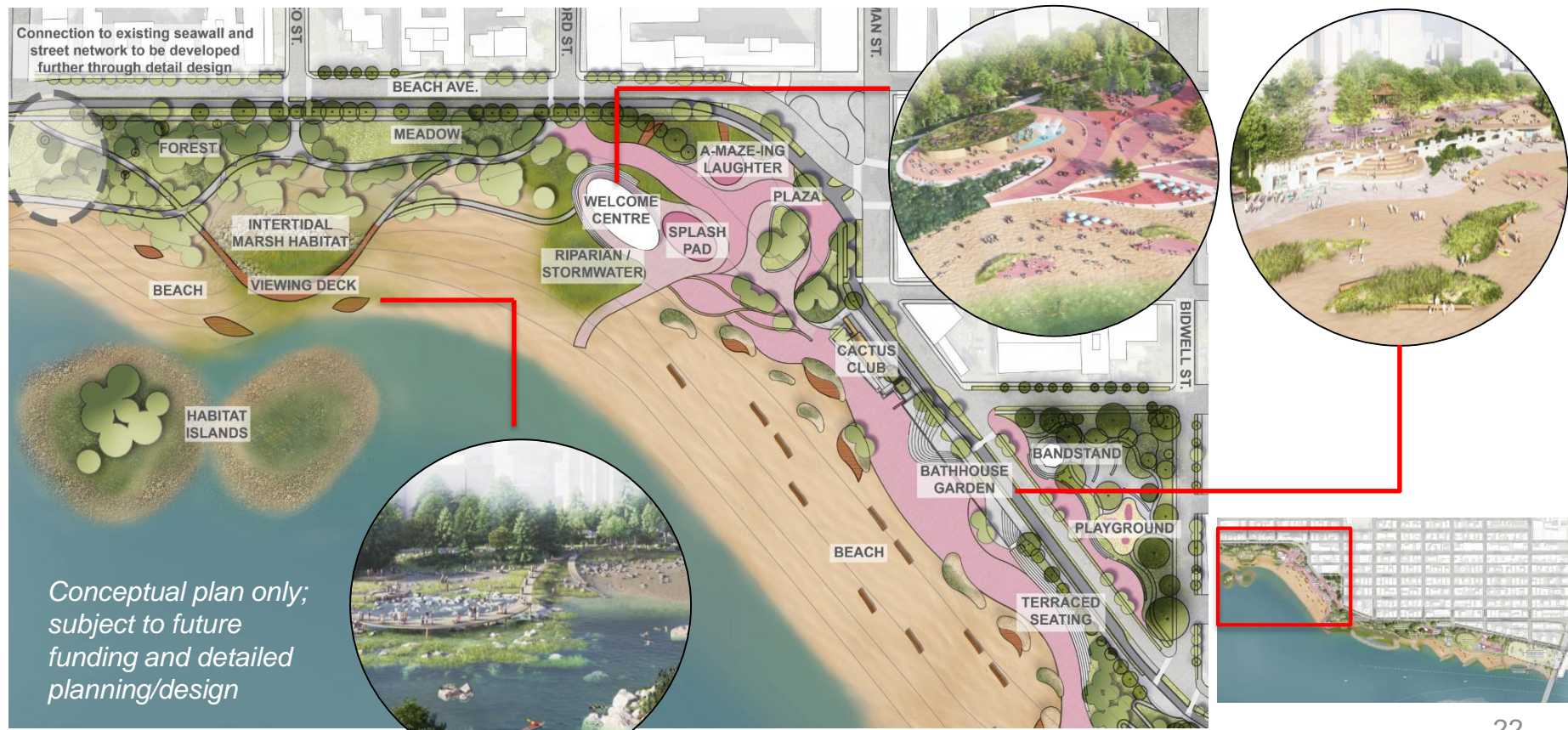

*Conceptual plan only;
subject to future
funding and detailed
planning/design*

Draft Concept Plan – Centre: ‘The Headland’ to Jervis Street



*Conceptual plan only;
subject to future
funding and detailed
planning/design*

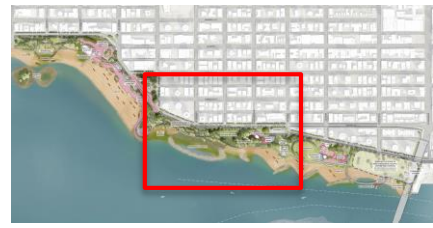

Draft Concept Plan – East: Sunset Beach Park & Van. Aquatic Centre

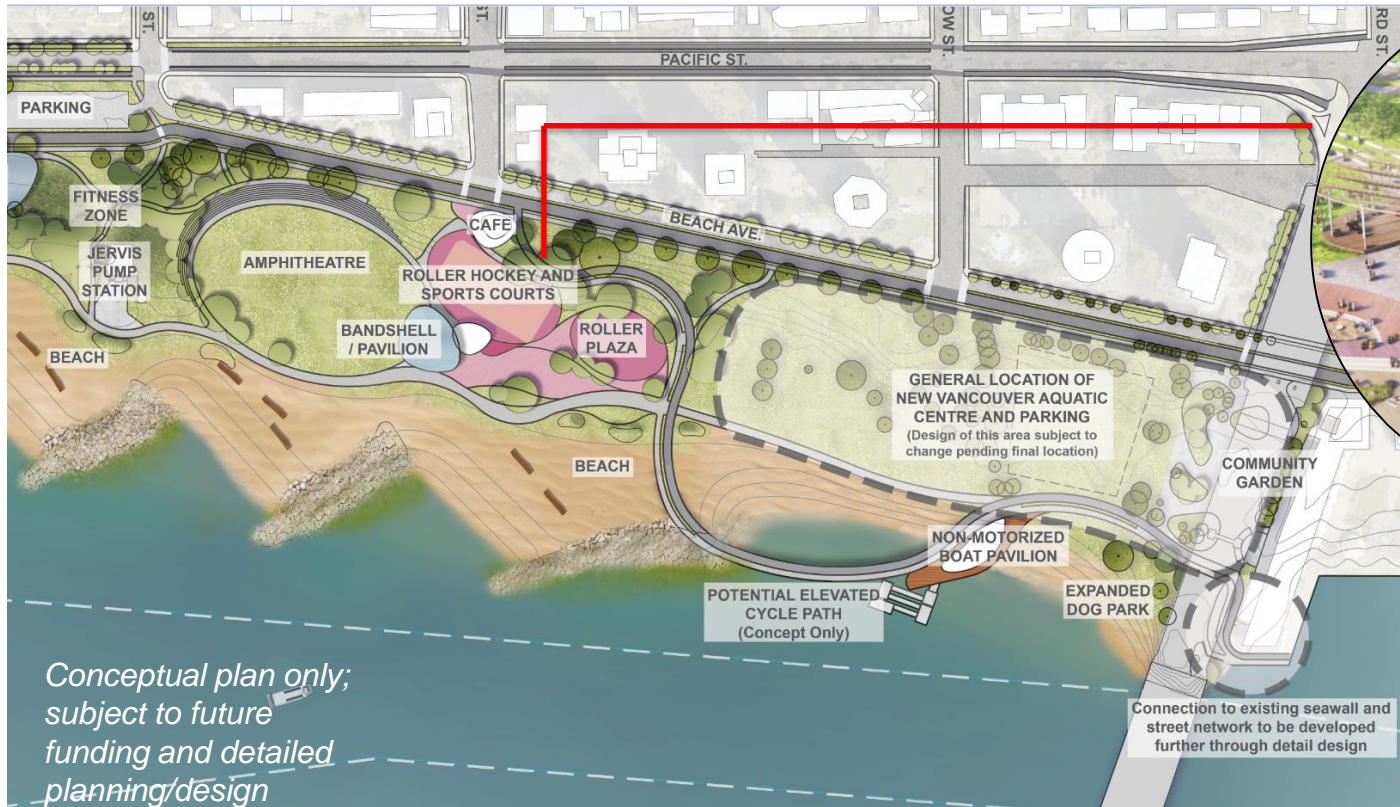

*Conceptual plan only;
subject to future
funding and detailed
planning/design*

Connection to existing seawall and street network to be developed further through detail design

Implementation Framework



Implementation Framework

- Park and beach improvements identified in West End Community Plan Public Benefits Strategy, with the added imperative to adapt to climate change and sea level rise.
- 30-year vision implemented within the City's capital framework:
 - Near Term – What we hope to deliver in this capital plan (2023-2026)
 - Mid Term – What we hope to accomplish in the next 10 years
 - Long Term – General direction for next 30+ years

Implementation Framework

- Distinguish **main project components**, in anticipation of different funding sources
- Imbed flexibility to right size and sequence projects over multiple capital plans
- Track impacts to operating budget and aim to balance revenue loss & gain in the long term

Main Project Components

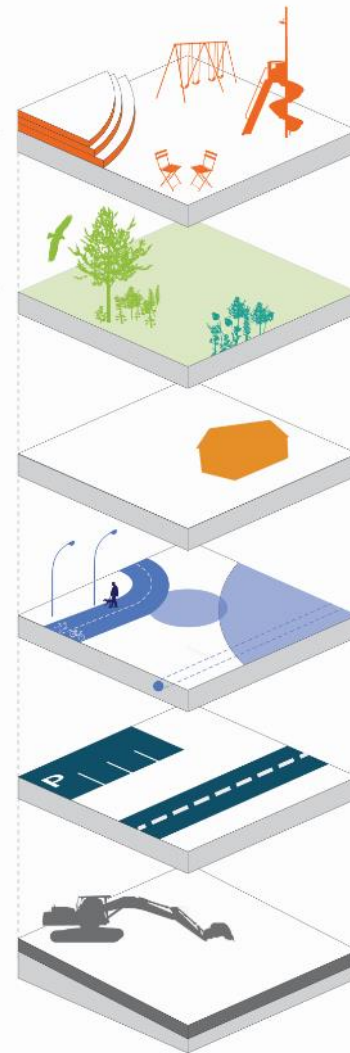

Park Amenities, Seating,
Furnishings

Green Space and Trees

Buildings

Utilities and Circulation

Roadworks

Site Preparation and
Climate Change Adaptation

Implementation Framework – Near Term

- **Phase 1**
 - \$10M in 2023-2026 Capital Plan for design and construction, including project management costs
 - Project scope to be determined in early 2024, for Park Board / Council decision as part of overall West End Waterfront Plan decision
 - If approved, anticipated detailed design in 2024-25 and construction start in 2026

Next Steps



Project Timeline (Upcoming Milestones)

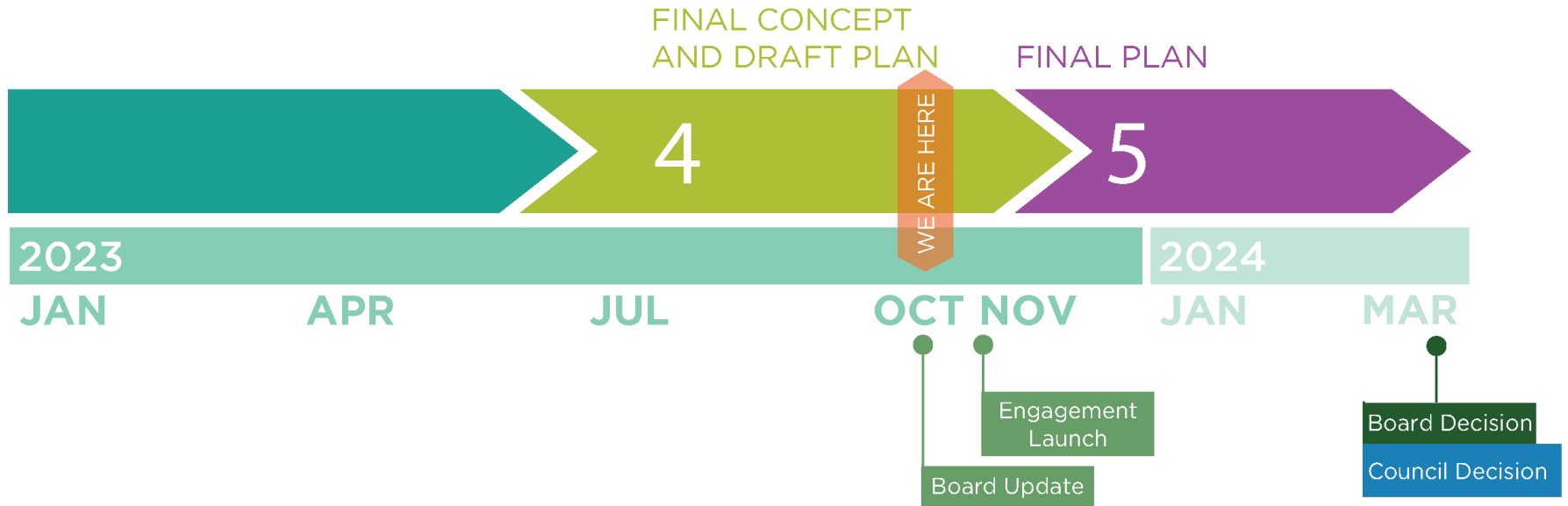

Opportunities to get involved

- Share feedback and ideas in the [online survey](#) (live until November 26)
- Take part in our open house events or take a self-guided tour of the project area: visit the [Shape Your City page](#) for details.
- Stay up to date with the project by visiting the [Project webpage](#) and signing up to the mailing list

Thank You

Q&A



Connection to existing seawall and street network to be developed further through detail design



Connection to existing seawall and street network to be developed further through detail design

West End Waterfront Draft Concept Plan

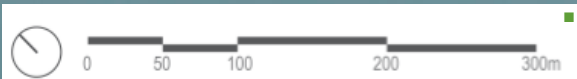

Conceptual plan only; subject to future funding and detailed planning/design

