



QUEEN ELIZABETH PARK LITTLE MOUNTAIN RESERVOIR MAINTENANCE

**Metro Vancouver Roof Slab
Repair Work Summer 2021**

Regular Board Meeting
Monday, February 22, 2021



Purpose of Presentation

Inform the board of rehabilitation work by Metro Vancouver taking place this summer in the parking area on the top of the QE Plaza, across from the QE Fountains



- Metro Vancouver assessed condition of the plaza and parking lot area in 2017
- Repairs recommended in parking lot area to maintain seal, structural slab
- Work must be done in warm, dry weather
- Staff including Business Services, Park Operations collaborating with Metro Vancouver on best approach for fastest completion

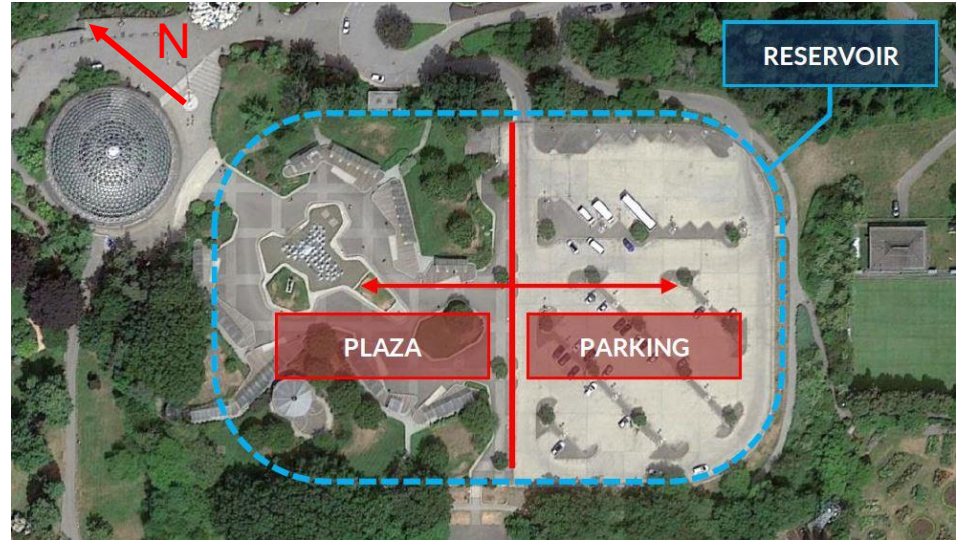

- Best approach for fastest completion is full closure for three months
- With lower tourism numbers expected due to COVID this summer, opportunity to do full parking lot closure to complete repairs
- Fewer or no tour buses and shuttle buses, fewer events
- Construction from **June 1 to August 31, 2021**
- Parking lot closed to buses and vehicles for this duration
- Based on no restrictions on construction activities for events and bookings during this period

1. Manage construction hours to maximize enjoyment for park users during peak periods
 - Regular Work from Monday to Friday from 7:30 AM to 8:00 PM
 - “Low Impact” Work on Fridays from 12:00 PM to 8:00 PM
 - No Work on Weekends or Holidays
2. Provide temporary alternative parking (including accessible spaces)
3. Limit construction access to the cul-de-sac

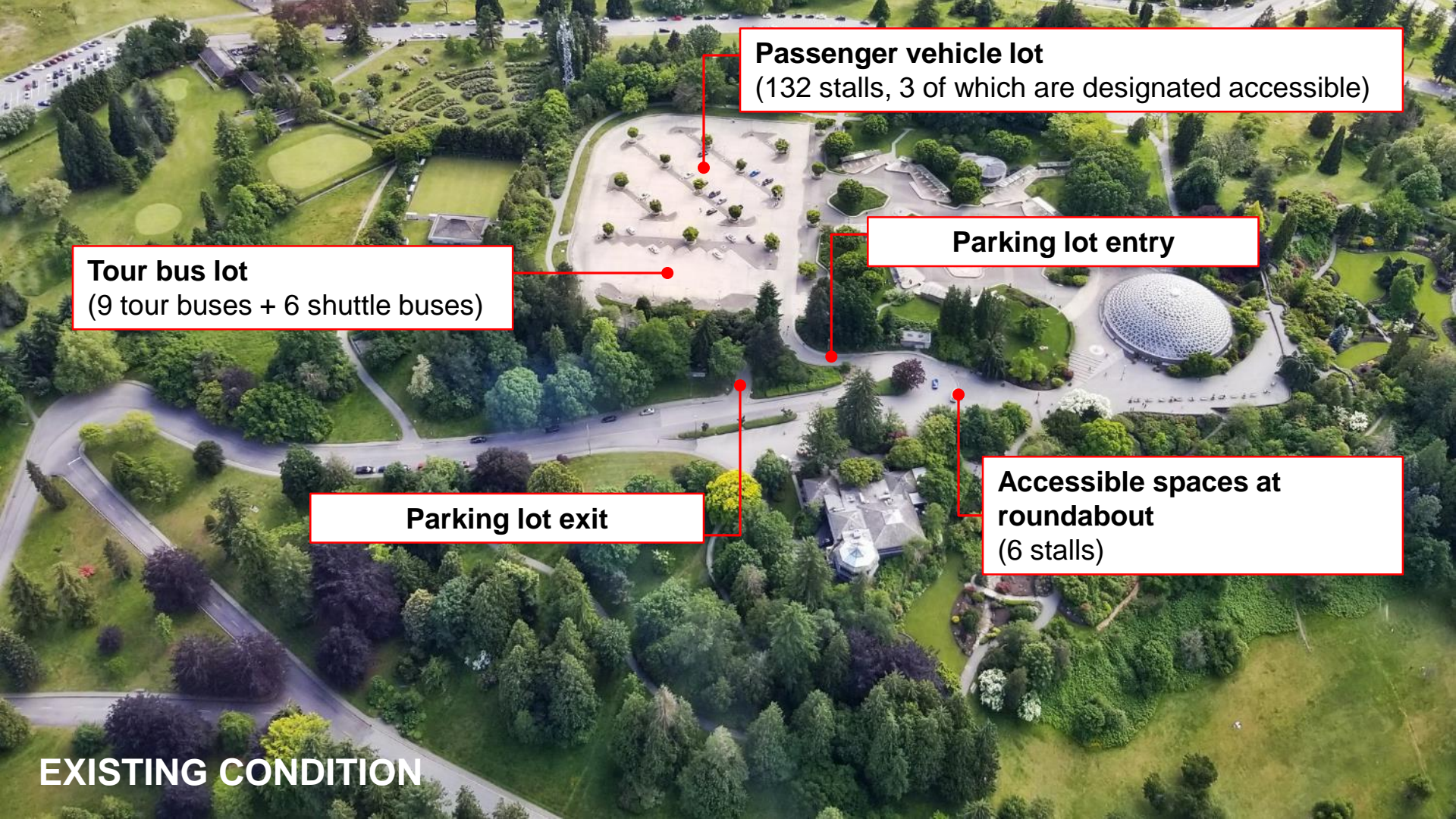

Passenger vehicle lot

(132 stalls, 3 of which are designated accessible)

Tour bus lot

(9 tour buses + 6 shuttle buses)

Parking lot entry

Parking lot exit

Accessible spaces at roundabout

(6 stalls)

EXISTING CONDITION

Passenger vehicle lot – Closed
(132 stalls, 3 of which are designated accessible)

Tour bus lot – Closed
(9 tour busses + 6 shuttle busses)

Parking lot entry – Closed

**Parking lot exit –
Construction Access Only**

**Accessible spaces at
roundabout**
(6 stalls + 3 temporary stalls)

+15 temporary stalls

DURING CONSTRUCTION



**Accessible spaces at roundabout
(6 stalls + 3 temporary stalls)**

DURING CONSTRUCTION

Temporary Accessible Parking at the Roundabout



Temporary Accessible Parking at the Roundabout

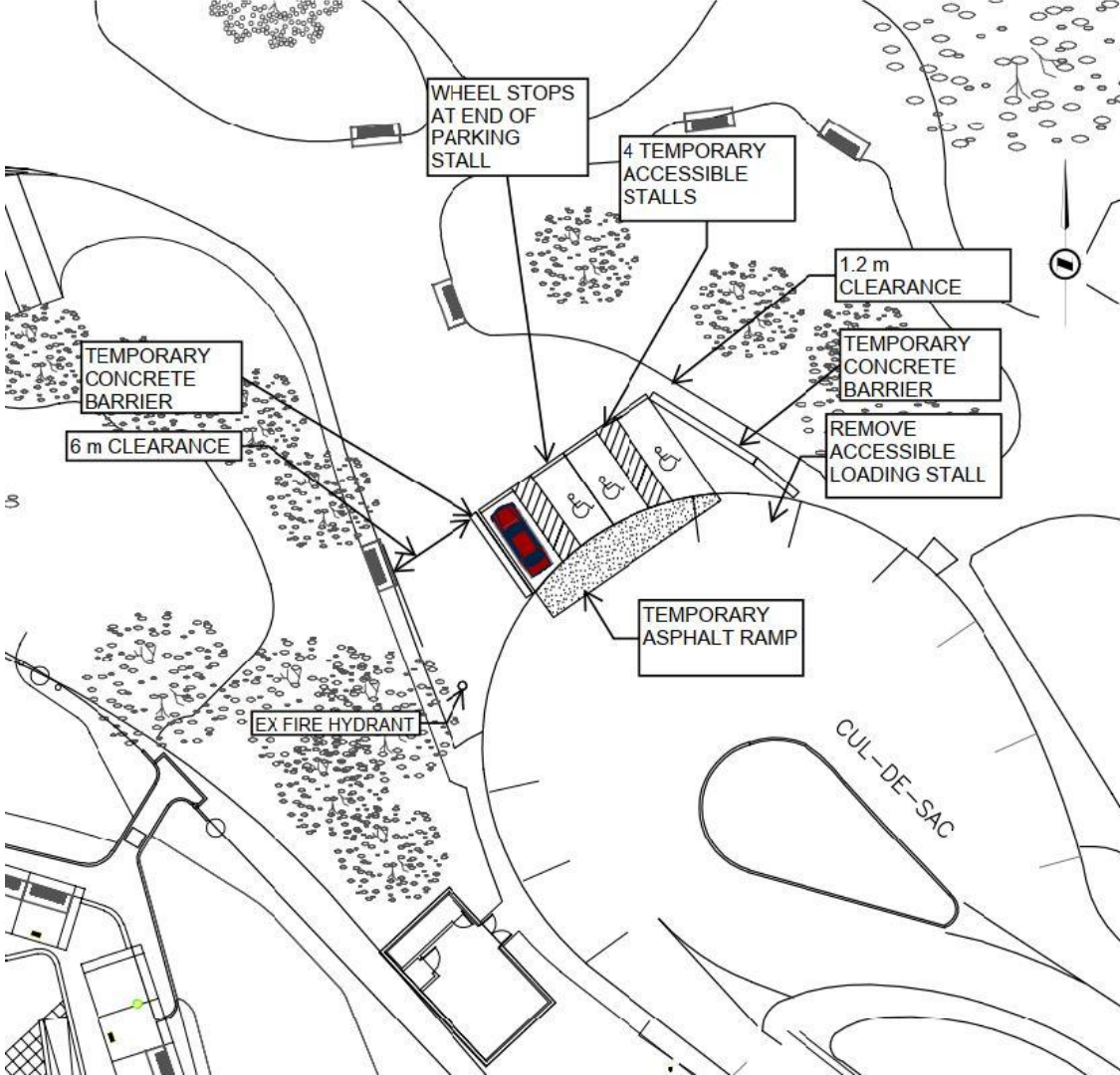



+15 temporary stalls

DURING CONSTRUCTION

Temporary Parking Along the Bypass Road

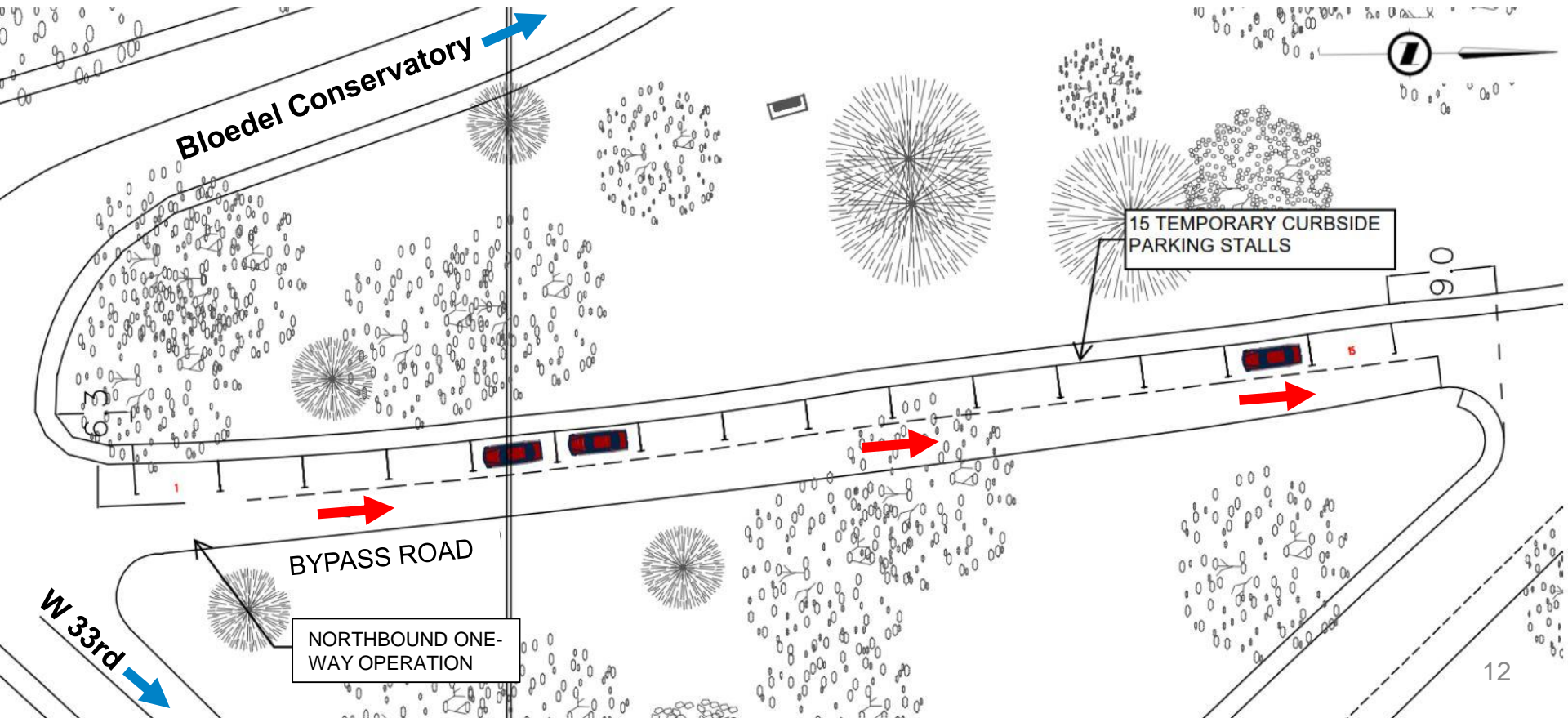

Total Number of Vehicle Parking Spaces in the Park

Parking Lot	Approx. # of Spaces	Construction
Main Lot	132	-132
Cul-de-sac	6	+3
Lot South of Bloedel	46	No change
Access Road (Bloedel)	>20*	No change
Pitch & Putt Lot	96	No change
Access Road (Rose Garden)	70	No change
Access Road (Bypass to Rose Garden)	>200**	+15
TOTAL	570	-114 (-20%)

No change in number of accessible parking spaces

- Metro Vancouver is leading communications for the project and collaborating with Parks communications staff on a communication plan, signage/wayfinding
- Ongoing discussions with Park stakeholders to mitigate impacts of construction

