



COOPERS' PARK

RENEWAL

Conceptual Plan

Park Board Committee Meeting
Monday, July 5, 2021



- Share results of public engagement process;
- Provide background information and share details of the proposed improvements in Coopers' Park; and
- Seek a Board decision to enable staff to progress to the detailed design stage.

Project Background



Coopers' Park

Project Background

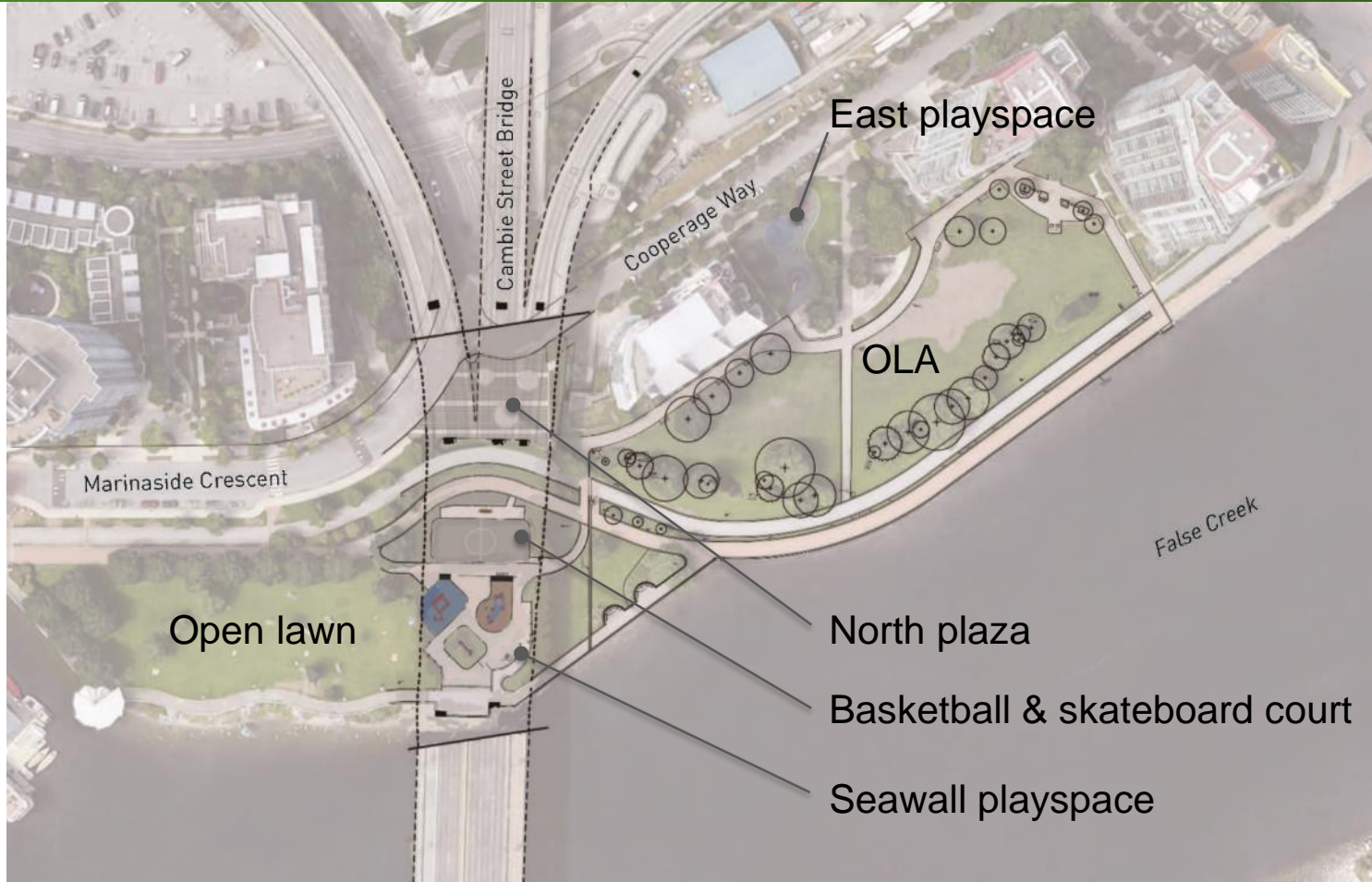

Project Background - Growth

City of Vancouver - 2011 to 2041 Projected Population Change

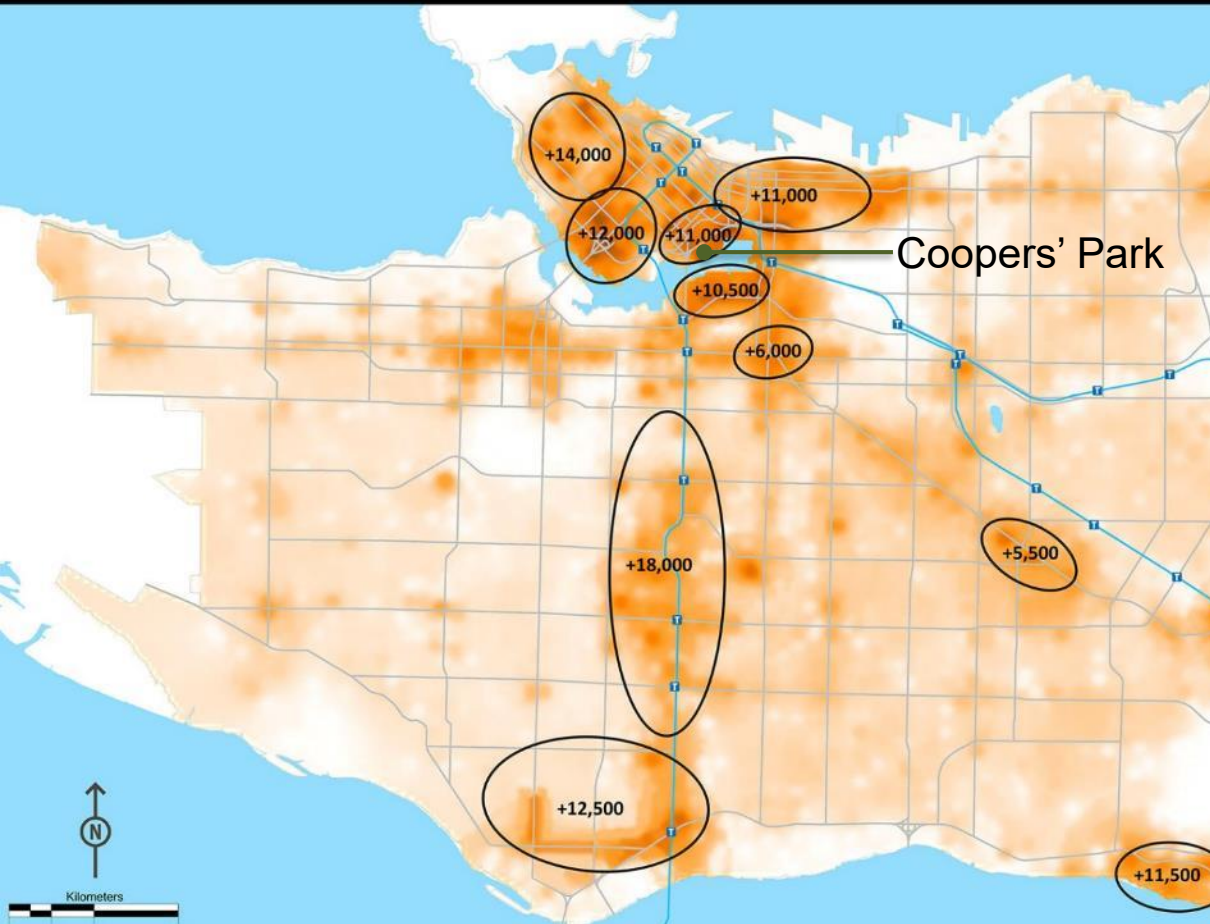

- Dense downtown neighbourhood with ongoing growth
- Seawall activity adds more visitors

INITIATIVE ZONES MAP

The Initiative Zones highlights historically underserved areas, so that projects, programs and resources can be focused geographically. The intent is to use this as one tool for setting priorities.

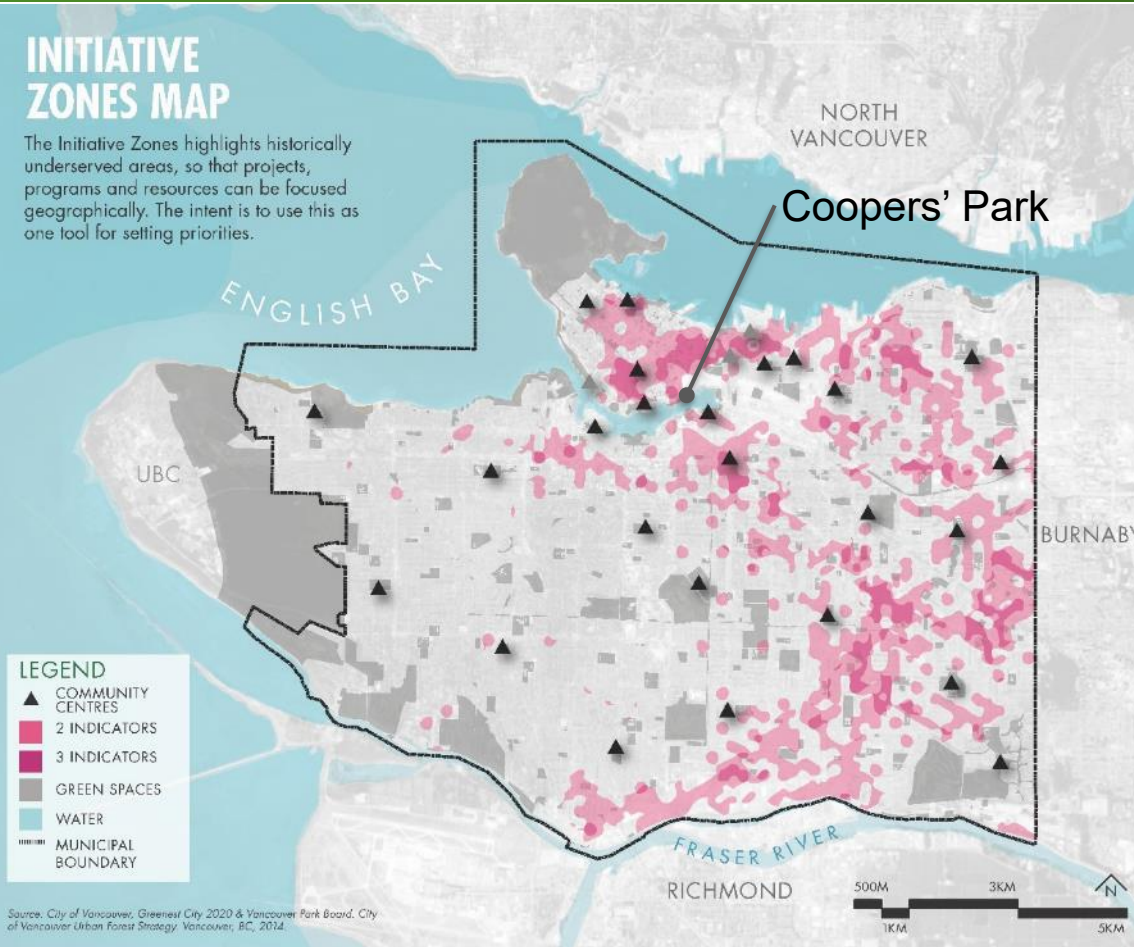

- Park area per capita (within 10 minute walk): 0.28 – 0.55ha/1000 persons
- Park overlaps with Initiative Zone
- Goal one: Grow and renew Parks, community centres and recreation assets to keep pace with population growth and evolving needs.

Project Background – North Plaza



- Eng. R.O.W.
- Opportunity for covered recreation
- Popular spot for fitness classes and parkour
- Already used throughout all seasons

Project Background – Seawall Playspace



- ~20 years old
- Surfacing needs replacement
- Outdated equipment
- Used throughout all seasons



- Largest OLA downtown
- Does not meet PPD guidelines (fencing, amenities)
- Grass surfacing not suitable



Discussion



Coopers' Park

- Process included two public open houses and three public questionnaires.
- Members of the public were asked to provide feedback on all proposed changes in the park.



Discussion – Public Engagement #1 May 2018



- **6 “Big Ideas”** presented for unique recreation amenity under the Cambie Bridge.
 - “Workout spot” - multiple fitness options presented
 - “Bright spot” – lighting and colour to create “sunshine” during grey winter
 - “Have you seen the_?” – big & bold interactive characters/objects
 - “The hang-out” – swinging and netting options presented
 - “A gateway” – colourful, interactive elements that take advantage of bridge columns
 - “Let’s climb” – options to turn columns and plaza into recreational climbing space
- **571** respondents completed questionnaire.

Discussion – Public Engagement #1

- A non-traditional “Workout Spot” to support parkour was most preferred, followed closely by “Have you seen the _?” and a “Bright Spot”
- Elements from all three included in proposed design.

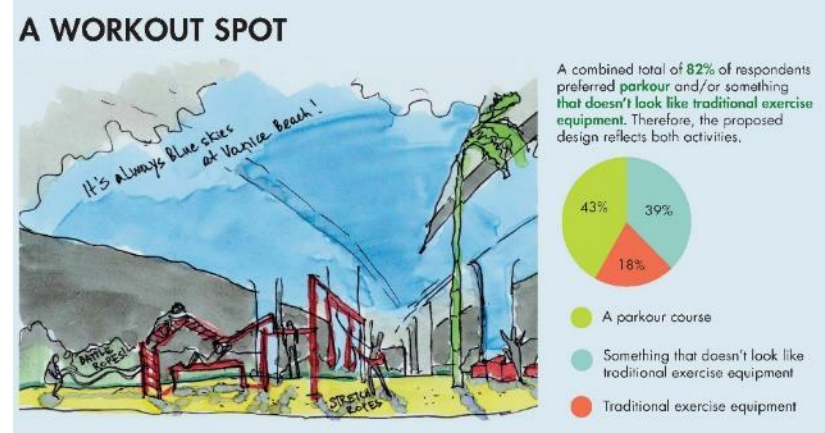

HAVE YOU SEEN THE _?

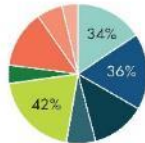
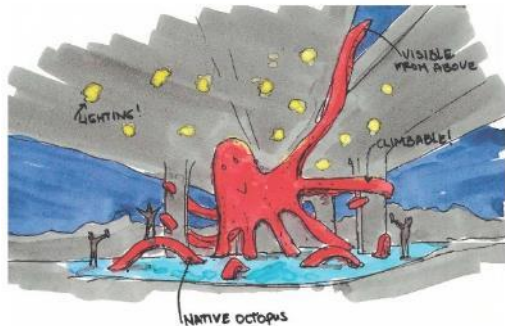

- It can be climbed on
- It lights up
- It's brightly coloured

A BRIGHT SPOT

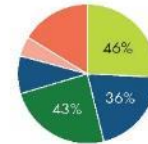
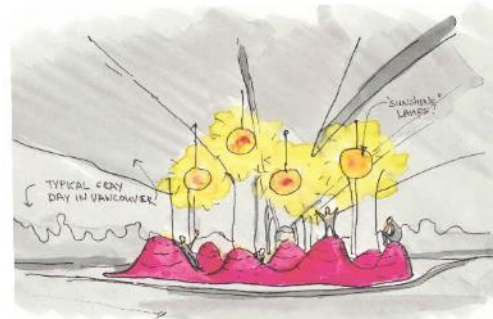

- It's very bright and colourful
- It's a place to get some "sunshine"
- It's interactive and reacts to either sound, motion, or temperature

Discussion – Public Engagement #2 September 2019



Discussion – Public Engagement #2 Fitness Area

- Pacific Northwest themed fitness area and play-space presented.
- **654** respondents completed questionnaire.

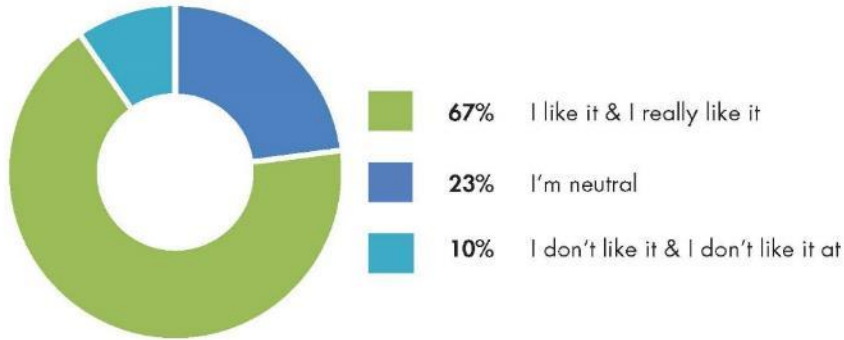

Do you like it?

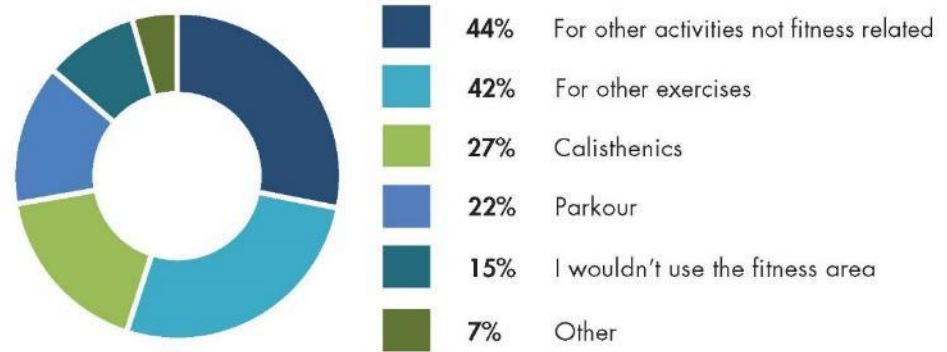

Would you use it?

Do you like it?

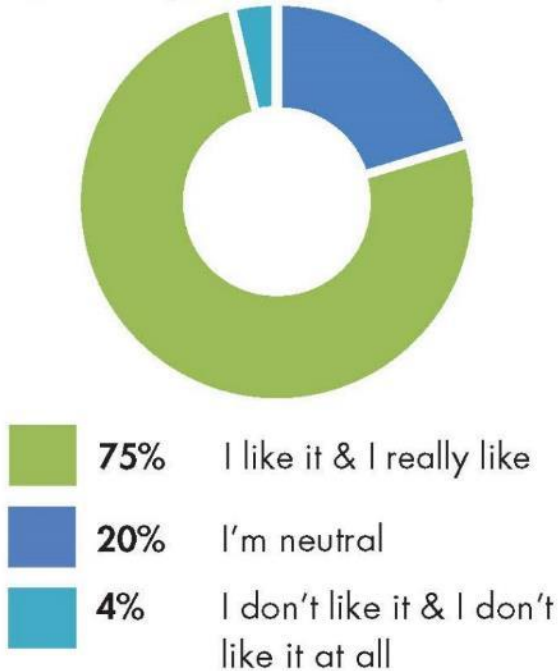

What features do you prefer?

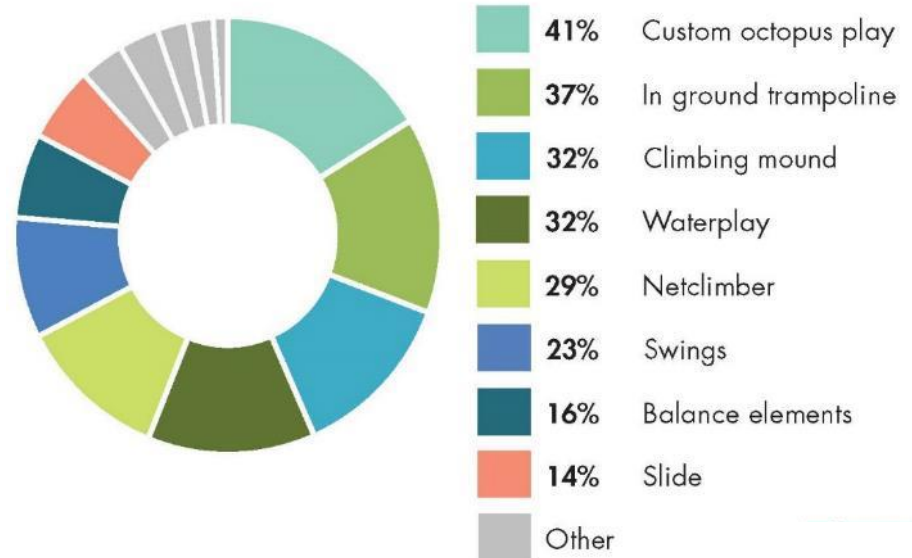

- Completed entirely online on Shape Your City platform

Coopers' Park dog off-leash area renewal



The Vancouver Park Board is planning a full renewal of the dog off-leash area (OLA) in Coopers' Park.

Improvements to the OLA are guided by the [People Parks & Dogs Strategy \(2017\)](#), with the goal of creating a safe and engaging park space for people with and without dogs.

In spring 2021, we received feedback on design options for proposed changes to the dog off-leash area through an online survey. Both the [public consultation summary](#) and the [revised concept plan](#) are now available. Please see the links below or the documents tab on this page.



- Draft concept for OLA renewal presented, with options for dog and human amenities.
- **465** respondents completed questionnaire.
- **74%** like or really like the concept & **84%** dog owners with highly active dogs.
- Most preferred amenity types:



Main concerns identified from 3 engagements included:

- Safety between cyclists and pedestrians;
- Need for a park washroom, lighting and drinking fountain;
- Inclusion of age-friendly fitness options and accessibility in play-space;
- Perceived reduced size of OLA; and
- Synthetic turf surfacing in renewed OLA.

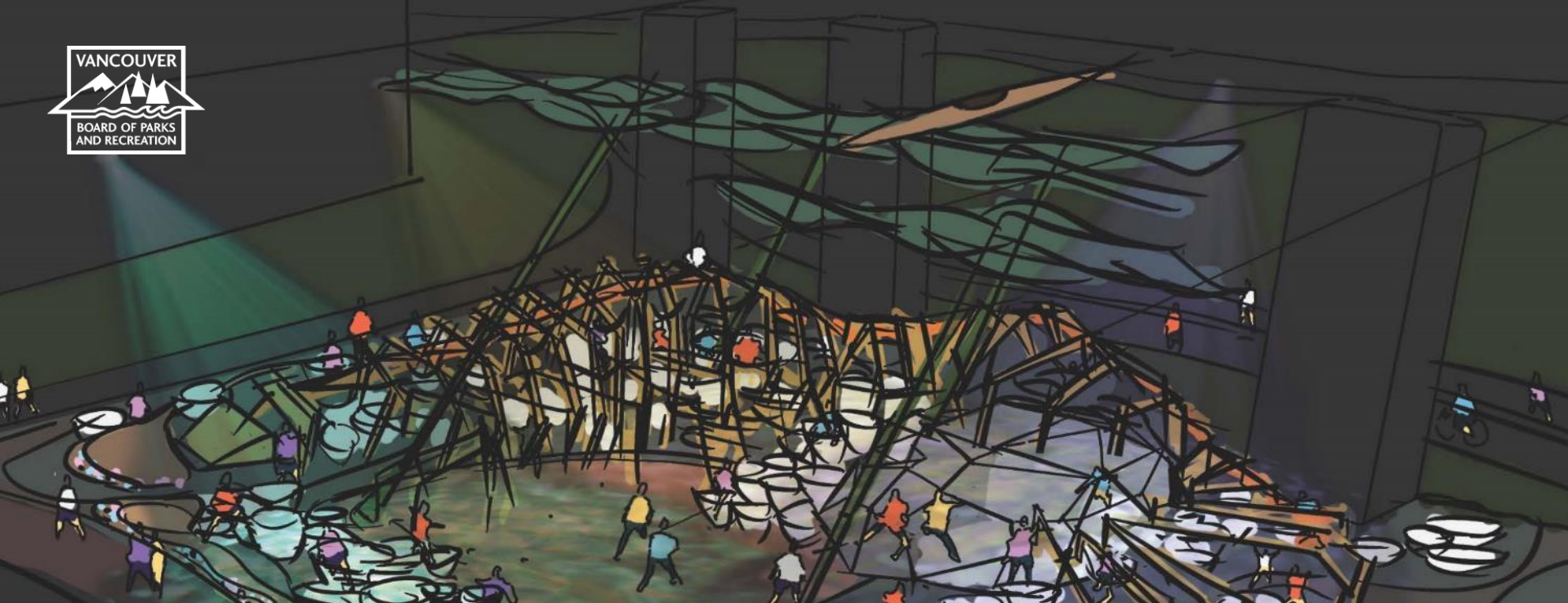

Design

Design – Fitness Area



Design – Fitness Area

- Custom fitness amenity inspired by our west coast environment.
- Incorporates elements from 3 most preferred “Big Ideas”
- Designed to support parkour and calisthenics.
- Working with local experts to ensure usability.

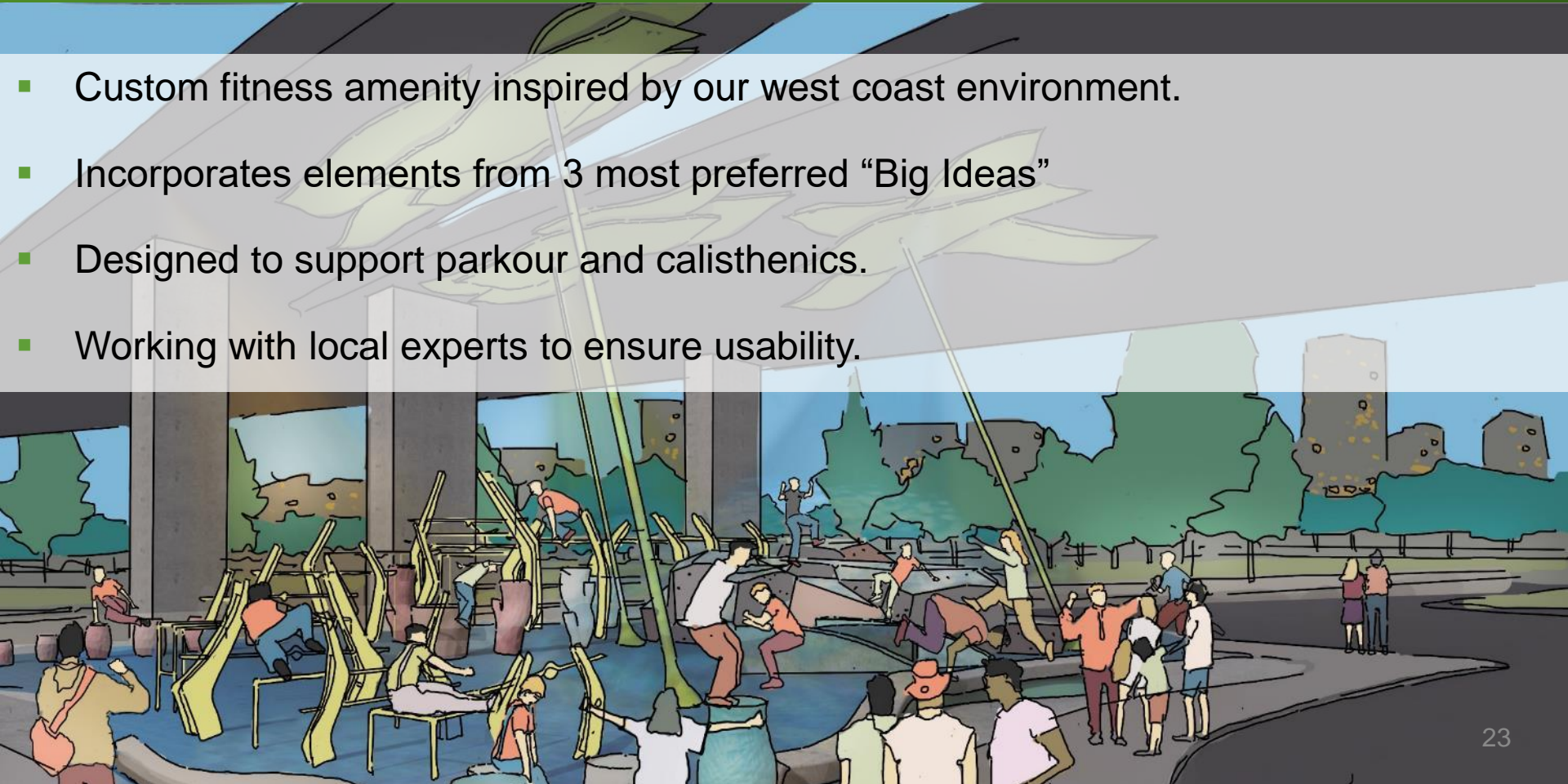

Element : Whale / Bar Framework



Various bars at different heights and spacing for parkour and calisthenics moves, such as:

- Chin ups
- Pull ups
- Leg raises
- Dips
- Underbars
- Lache
- Planche
- Bar kip
- Human flag
- Dyno
- Swinging Through
- Attaching TRX bands

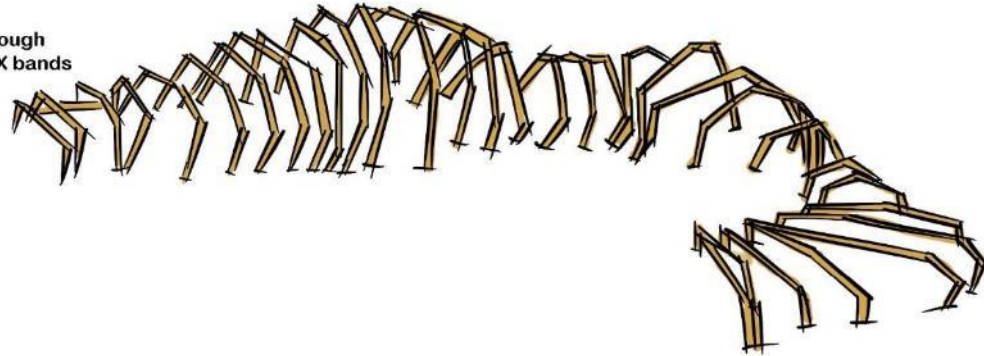

Element : Rocky Outcrop



Large faceted “rock” mass for various climbing and parkour movements such as:

- Cat leap
- Wall run
- Tic tac
- Climb up
- Drop

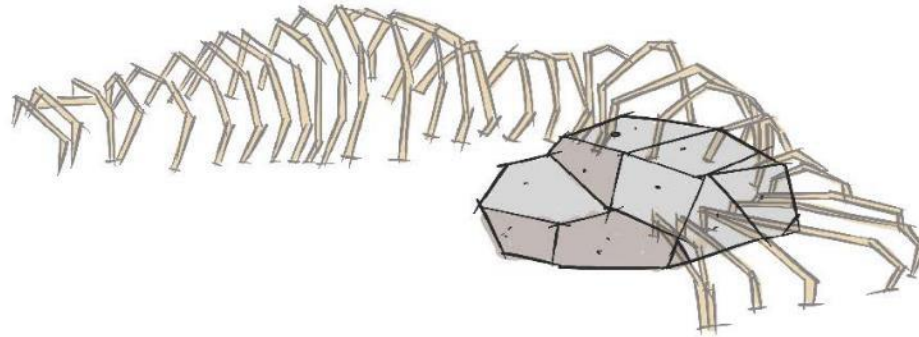

Element : Glass sponges



Small “rock” elements for various parkour, crossfit and calinsthetics movements such as:

- Kong vault
- Lazy vault
- Monkey vault
- Precision jump
- Steps ups
- Box jumps
- Elevated pushups
- Split squats

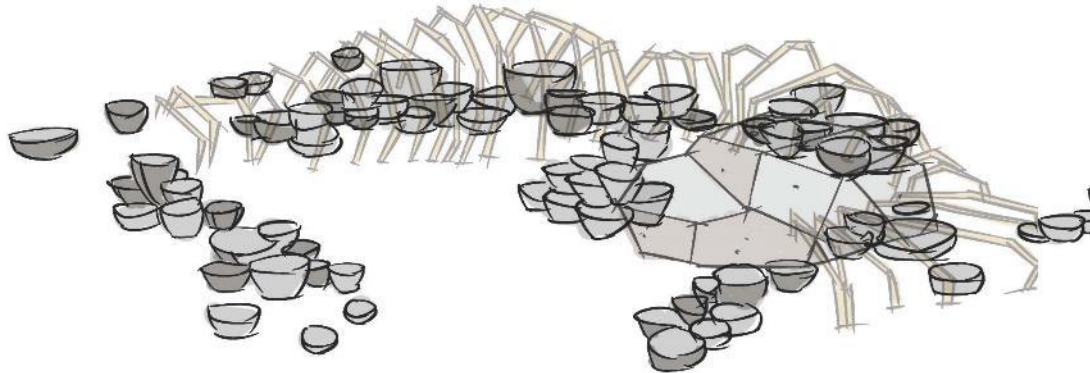

Element : Bull Kelp



“Bull Kelp” elements create an iconic presence, visually connect to the bridge structure, and create exciting photo ops. They are suitable for various parkour, crossfit and calisthenics movements such as:

- TRX Bands
- Battle ropes
- Kick offs
- Wall run





INTEGRATED LIGHTING

- Spot or strip lighting will illuminate feature elements to make them usable and visible during evening hours

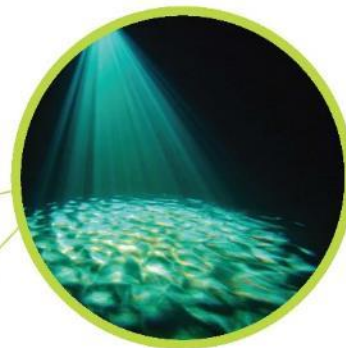
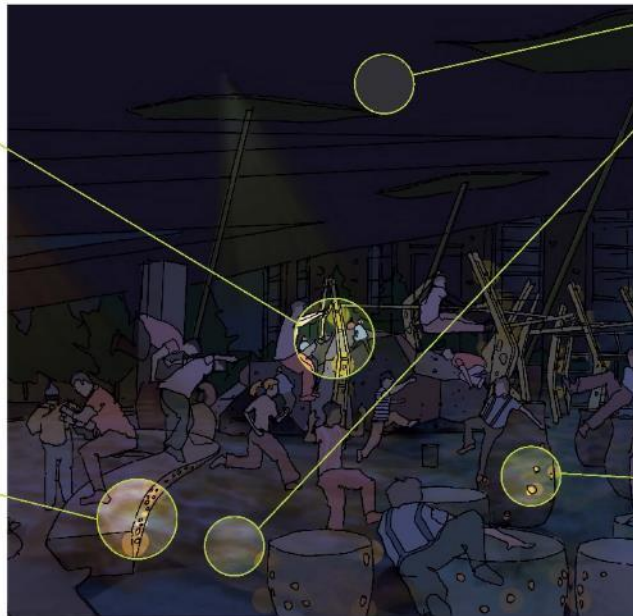

UPLIGHTING / DOWNLIGHTING

- Underside of bridge as a canvas for lighting effects
- Lighting can be modified for events
- Water effect will support the under-the-sea theme



INTERNAL LIGHTING

- Elements can be lit internally to provide sculptural interest in the evening

VIDEO DEMO



Design – Fitness Area



Design – Fitness Area

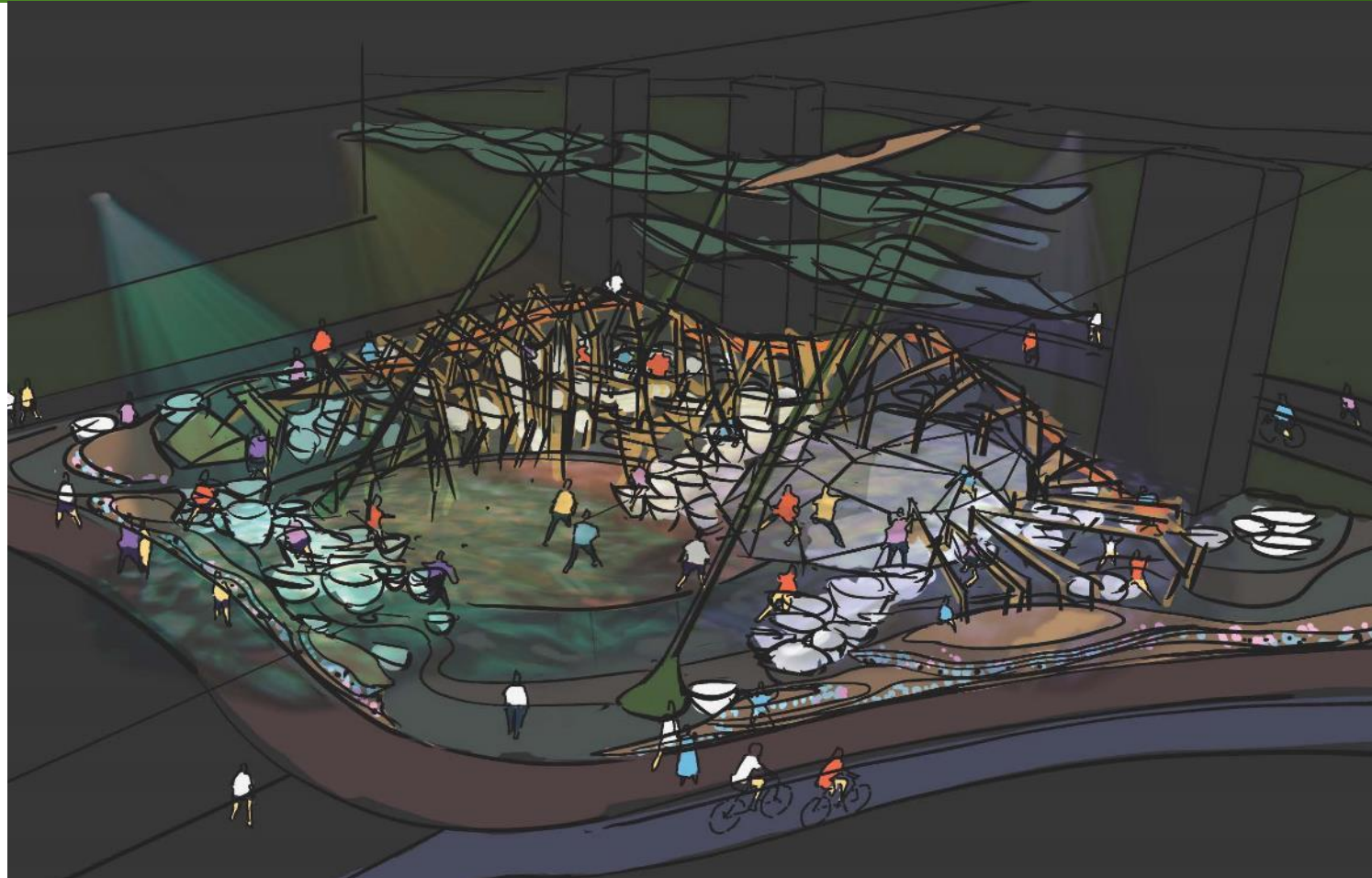

Design – Play-space



DESIGN INSPIRATION



FISHNET



AQUATIC WILDLIFE



TIDAL POOL



LOW TIDE

DESIGN ELEMENTS



MESH PLAY STRUCTURE



OCTOPUS SLIDE

CLIMBING PLAY



WATER PLAY



CLIMBING PLAY

RESTING

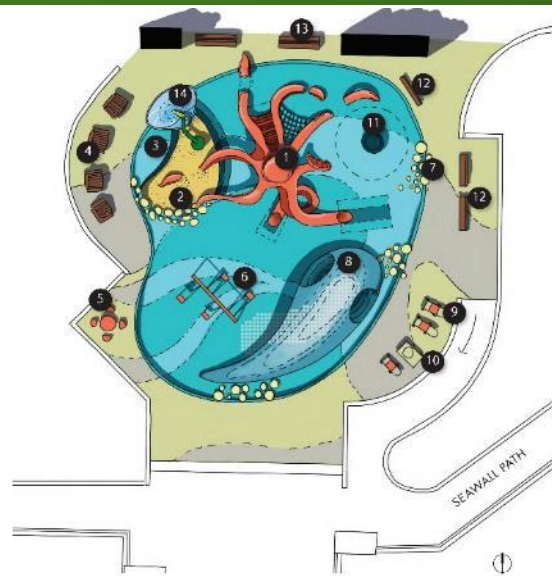

Legend

- 1 OCTO CLIMBER WITH SLIDE, NETS
- 2 SANDPLAY
- 3 ACCESSIBLE PAD
- 4 ADIRONDACK CHAIRS
- 5 PICNIC TABLE
- 6 SWINGS
- TOT
- BELT-HALL
- ACCESSIBLE
- FRIENDSHIP
- 7 "GLASS SPONGE" STEPPING STONES
- 8 RESILIENT MOUND WITH HANDHOLDS AND A TUNNEL
- 9 STROLLER PARKING
- 10 DRINKING FOUNTAIN
- 11 SPINNER
- 12 BENCH
- 13 TWO SIDED BENCHES
- 14 WATER PLAY



Design – Dog Off-Leash Area



- PPD strategy Design Guidelines
- ‘Neighbourhood Urban’ OLA.

DESIGN RECOMMENDATIONS FROM THE PEOPLE, PARKS & DOGS STRATEGY

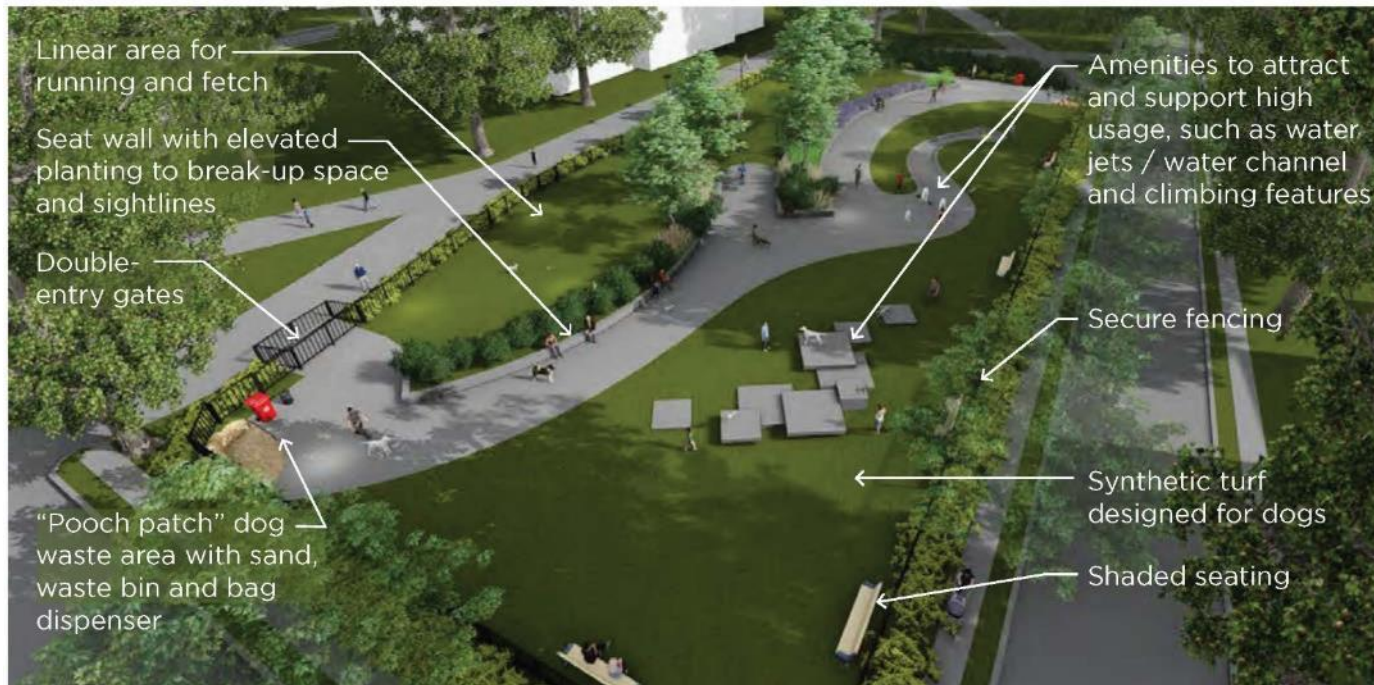

Size: From 0.04 to 0.4 ha (0.1 to 1 acre)



Boundaries: secure, high quality fencing



Circulation: Designed to reduce congestion



Surfacing: Durable, specialty surfacing



Adjacencies: More compatible adjacencies



Standard and special amenities to attract and support high use, such as water play and agility features

Graphics: People Parks & Dogs: A strategy for sharing Vancouver's parks (VPB October 2017)

Revised OLA design:

- Pulls fencing closer to seawall to expand useable area
- Synthetic turf in central dog run, with added sand and lawn on edges
- Includes sheltered areas, wood seating and lighting
- Also includes preferred agility and water play elements

Design – Dog off-leash area



Features and amenities

- 1 Double-gated accessible entry
- 2 Trash receptacles
- 3 Accessible walking path
- 4 Runnels
- 5 Mounds
- 6 Secure fence

Other improvements

- 7 Playground safety improvements

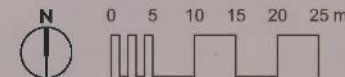

Other Improvements - Washroom (Board Approved 2020)



An accessible, single stall washroom with exterior hand wash station and nearby drinking fountain will be installed in Coopers' Park in 2021.

- New park washroom approved by Board in 2020

- Drinking fountain will be sited during detail design

- Addition of age-friendly fitness equipment to be added during detail design

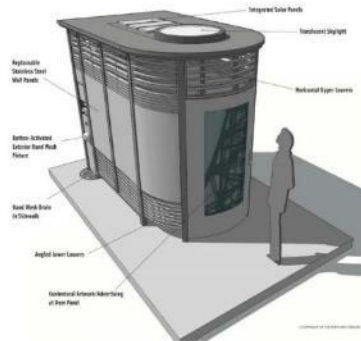

Considerations & Next Steps



Coopers' Park

- The north plaza currently operated as a connection for people walking and cycling between the seawall, Cambie Bridge and Pacific Blvd.
- Engineering staff are developing plans for separated cycling facility between seawall and Pacific Blvd. along with pedestrian improvements
- Park Board staff are further exploring wayfinding improvements for the park circulation network

- High level estimate of \$3.2M to 4M for all improvements in Coopers' Park
- Estimated annual maintenance increase in range of \$96,000 to \$120,000 per year
- Budget will be refined during detail design
- Park would benefit from onsite programming due to urban location and anticipated high utilization and will be considered as the Downtown Parks activation project advances.

Pending Board decision staff will proceed to:

- Detail design, tender and award for construction contracts
- Board approval of construction contracts will be required as the budget will exceed \$500,000

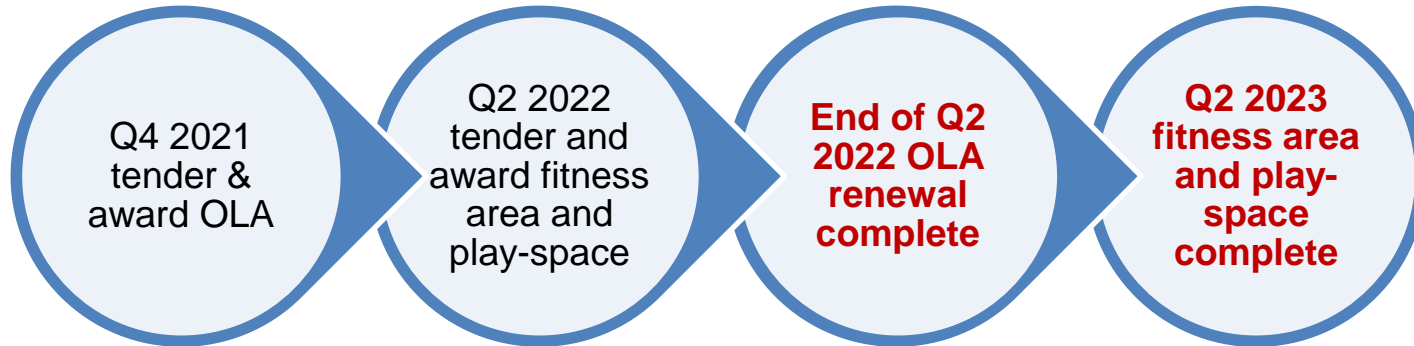

- Timelines subjects to change pending procurement and award process and staff will update Board as project progresses

THAT the Vancouver Park Board approve the proposed Concept Plan for a new fitness area, and renewal of the existing playground and dog off-leash area planned for Coopers' Park, as outlined in this report and as shown in Figures 2 to 4.



